

NOTICE OF MEETING OF THE  
COMMISSIONERS' COURT OF TITUS COUNTY, TEXAS

Notice is hereby given that a Special Meeting of the Commissioners' Court of Titus County, Texas, will be held on the 28th day of January, 2008, at 9:00 o'clock A.M., in the Titus County Courthouse, County Courtroom, 100 West First Street, Suite 205, Mt Pleasant TX 75455, at which time the following subjects will be discussed not necessarily in the order presented:

PLEDGE OF ALLEGIANCE

-----

INVOCATION

1. Public comments and/or requests for information on non-agenda items in accordance with Section 551.042, Texas Open Meetings Act
  - a. Report on roofing project – Phil Engle
2. Consider and possibly approve minutes for Commissioners' Court on January 14, 2008
3. Consider and possibly approve Plat of Chapel Hill Estates – Phase II of the George Clapham Survey, Abstract No. 102, Titus County, Texas, County Road 4240
4. Consider and possibly approve Appointments to the Titus County Historical Commission for the 2008-<sup>7</sup>2009 Term
5. Consider and possibly approve reappointment of Hudson Old to the NET RMA Board of Directors beginning February 1, 2008
6. Consider and possibly approve travel and seminars for Titus County employees and elected officials
7. Approve oral and written reports of county officials
8. Approve budget amendments
9. Sign pay orders and approve payments
10. Closing comments by County Judge and Commissioners, if any

ADJOURN

Commissioners' Court of Titus County, Texas

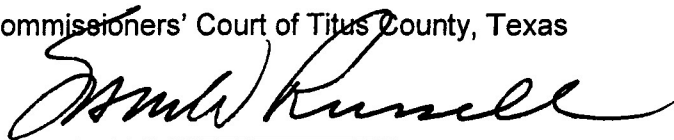

County Judge

I, the undersigned County Clerk, do hereby certify that the above Notice of Meeting of the Commissioners' Court of Titus County, Texas, is a true and correct copy of said Notice, and that I posted a true and correct copy of said Notice on the bulletin board and doors of the Titus County Courthouse and Annex, places readily accessible to the general public at all times, prior to 9:00 o'clock A.M., on the 25th day of January, 2008, and remained so posted for at least 72 hours preceding the scheduled time of said meeting.



County Clerk /Deputy County Clerk

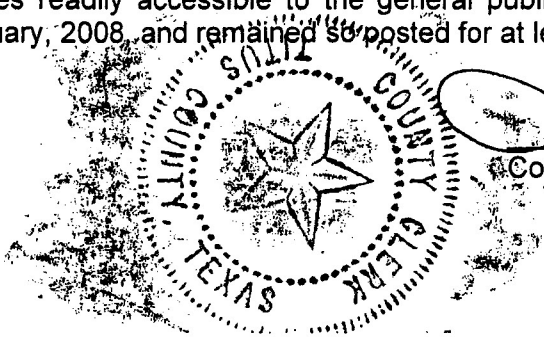

NOTICE OF MEETING OF THE  
COMMISSIONERS' COURT OF TITUS COUNTY, TEXAS

Notice is hereby given that a Special Meeting of the Commissioners' Court of Titus County, Texas, will be held on the 28th day of January, 2008, at 9:00 o'clock A.M., in the Titus County Courthouse, County Courtroom, 100 West First Street, Suite 205, Mt Pleasant TX 75455, at which time the following subjects will be discussed not necessarily in the order presented:

PLEDGE OF ALLEGIANCE

----

INVOCATION

1. Public comments and/or requests for information on non-agenda items in accordance with Section 551.042, Texas Open Meetings Act
  - a. Report on roofing project – Phil Engle
2. Consider and possibly approve minutes for Commissioners' Court on January 14, 2008
3. Consider and possibly approve Plat of Chapel Hill Estates – Phase II of the George Clapham Survey, Abstract No. 102, Titus County, Texas, County Road 4240
4. Consider and possibly approve Appointments to the Titus County Historical Commission for the 2008-2009 Term
5. Consider and possibly approve reappointment of Hudson Old to the NET RMA Board of Directors beginning February 1, 2008
6. Consider and possibly approve travel and seminars for Titus County employees and elected officials
7. Approve oral and written reports of county officials
8. Approve budget amendments
9. Sign pay orders and approve payments
10. Closing comments by County Judge and Commissioners, if any

ADJOURN

Commissioners' Court of Titus County, Texas

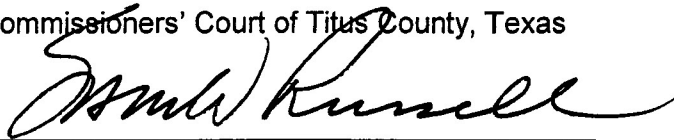

County Judge

I, the undersigned County Clerk, do hereby certify that the above Notice of Meeting of the Commissioners' Court of Titus County, Texas, is a true and correct copy of said Notice, and that I posted a true and correct copy of said Notice on the bulletin board and doors of the Titus County Courthouse and Annex, places readily accessible to the general public at all times, prior to 9:00 o'clock A.M., on the 25th day of January, 2008, and remained so posted for at least 72 hours preceding the scheduled time of said meeting.



County Clerk /Deputy County Clerk

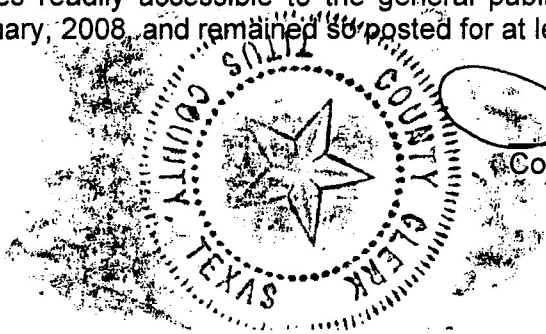

The above and foregoing minutes for January 14, 2008, were read and approved this 28th day of January, 2008.



---

SAM W. RUSSELL, COUNTY JUDGE

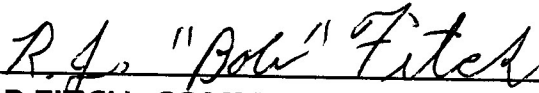

---

BOB FITCH, COMMISSIONER PRECINCT #1



---

MIKE FIELDS, COMMISSIONER PRECINCT #2

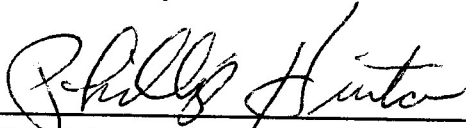

---

PHILLIP HINTON, COMMISSIONER PRECINCT #3

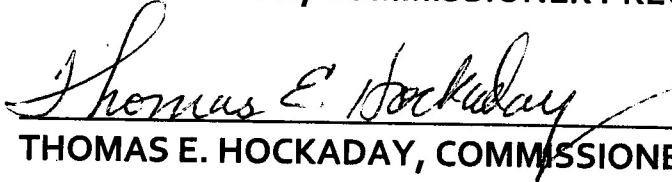

---

THOMAS E. HOCKADAY, COMMISSIONER PRECINCT #4

---

TERESA PRICE, COUNTY CLERK

**COMMISSIONERS' COURT  
REGULAR MEETING  
JANUARY 14, 2008**

BE IT REMEMBERED THAT THE TITUS COUNTY COMMISSIONERS' COURT met in a regular meeting on Monday, January 14, 2008, in the Titus County Courtroom with the following members present:

SAM W. RUSSELL	COUNTY JUDGE
BOB FITCH	COMMISSIONER PRECINCT 1
MIKE FIELDS	COMMISSIONER PRECINCT 2
PHILLIP HINTON	COMMISSIONER PRECINCT 3
THOMAS HOCKADAY	COMMISSIONER PRECINCT 4
TERESA PRICE	COUNTY CLERK

**PUBLIC AND COUNTY OFFICIALS ATTENDING MEETINGS**

Norma Narramore	Jake Narramore	Gerry Evenwel	Sue Evenwel
Ron Stagg	Brett Thomas	Scott Young	Arvel Shepard
Debbie Rhea	Carl Johnson	Joyce Simpson	Ashley Tompkins

**1. IN THE MATTER OF PUBLIC COMMENTS AND/OR REQUESTS FOR INFORMATION ON NON-AGENDA ITEMS IN ACCORDANCE WITH SECTION 551-042, TEXAS OPEN MEETINGS ACT.**

A. Update on Loop Project – Scott Young

**2. IN THE MATTER OF CONSIDERING AND POSSIBLY APPROVING THE MINUTES FOR DECEMBER 21, 2007.**

Motion was made by Commissioner Bob Fitch and was seconded by Commissioner Phillip Hinton to approve the foregoing minutes.

Motion carried unanimously.

SEE ATTACHMENT # 2

**3. IN THE MATTER OF CONSIDERING AND POSSIBLY APPROVE REPLAT OF A PART OF LOT 2, BLOCK 371 OF THE CITY OF MT. PLEASANT, WAL-MART STORE #131, MURPHY USA STORE #5665.**

Motion was made by Commissioner Thomas Hockaday and was seconded by Commissioner Phillip Hinton to approve the replat.

Motion carried unanimously.

**4. IN THE MATTER OF CONSIDERING AND POSSIBLY APPROVE FINAL PLAT OF NORTHWOOD SUBDIVISION PHASE 1 IN THE WM. PORTER SURVEY, A-437, TITUS COUNTY, TEXAS.**

Motion was made by Commissioner Bob Fitch and was seconded by Commissioner Mike Fields to approve the final plat.

Motion carried unanimously.

**5. IN THE MATTER OF CONSIDERING AND POSSIBLY APPROVE NOMINATIONS FOR REGIONAL CRIMINAL JUSTICE ADVISORY COMMITTEE.**

Nominations were Miguel Larson, Sharyn Cary, and Kay McNutt with the fourth to be nominated at a later time.

Motion was made by Commissioner Mike Fields and was seconded by Commissioner Bob Fitch to approve the nominations for the Criminal Justice Advisory Committee.

Motion carried unanimously.

SEE ATTACHMENT #5



**6. IN THE MATTER OF CONSIDERING AND POSSIBLY APPROVE SERVICE PROVIDER AGREEMENT WITH PAYMENTECH, LLC AND NET DATA CORPORATION TO ACCEPT PAYMENTS BY CREDIT OR DEBIT CARD.**

Motion was made by Commissioner Mike Fields and was seconded by Commissioner Bob Fitch to table this item until the County Attorney can preview and then place back on the agenda.

Motion carried unanimously.

**7. IN THE MATTER OF CONSIDERING AND POSSIBLY APPROVING TRAVEL AND SEMINARS FOR TITUS COUNTY EMPLOYEES AND ELECTED OFFICIALS.**

Motion was made by Commissioner Phillip Hinton and was seconded by Commissioner Mike Fields to approve all travel plans.

Motion carried unanimously

SEE ATTACHMENT #7

**8. IN THE MATTER OF CONSIDERING AND POSSIBLY APPROVING ORAL AND WRITTEN REPORTS OF COUNTY OFFICIALS.**

Motion was made by Commissioner Bob Fitch and was seconded by Commissioner Phillip Hinton to approve reports.

Motion carried unanimously.

SEE ATTACHMENT # 8

**9. IN THE MATTER OF CONSIDERING AND POSSIBLY APPROVING BUDGET ADJUSTMENTS.**

Motion was made by Commissioner Thomas Hockaday and was seconded by Commissioner Phillip Hinton to approve budget adjustments.

Motion carried unanimously

SEE ATTACHMENT # 9

**10. IN THE MATTER OF SIGNING PAY ORDERS AND APPROVING PAYMENTS.**

Motion was made by Commissioner Phillip Hinton and seconded by Commissioner Bob Fitch to approve.

Motion carried.

SEE ATTACHMENT # 10

**11. IN THE MATTER OF ADJOURNMENT.**

Motion was made by Commissioner Thomas Hockaday and seconded by Commissioner Phillip Hinton to adjourn.

Motion carried unanimously.

Sunday, January 22, 2008

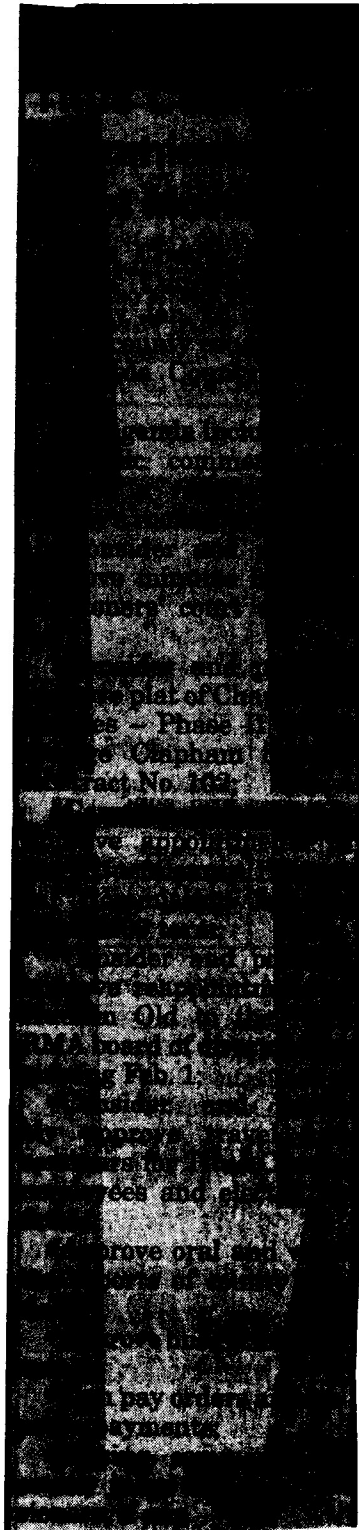



TRIBUNE photo by Ashley Tompkins

Despite the frigid weather Monday, crews worked on the roof of the Witt Building, owned by Titus County. The building is one of several to receive repairs following years of damage and leaks.

## Work proceeds on roofing fix

By **ASHLEY TOMPKINS**  
Tribune City Editor

Mount Pleasant residents visiting the downtown area should get accustomed to the smell of hot tar currently drifting from the roof of the Titus County Courthouse Annex as work is slated to continue in coming months on the county's roof project.

Commissioners were updated on the more than \$450,000 project - which includes the main courthouse, annex, elections office and Titus County Sheriff's Office and jail - on Monday and were told progress is being made.

"We're impressed with the job so far," said Precinct 2 Commissioner Mike Fields, who filled in Monday for absent Titus County Judge Sam Howell. "They've really made a lot of progress."

Project work will continue

roofs began when they were initially put on. Holes in flashings and roof mats, a gap between two roofs at the annex, and a lack of drainage have all contributed to the leaky roofs.

All but the sheriff's office and jail roof have been worked on in some fashion since work began late last year.

Currently, crews have set up home on the Witt building, recently purchased by the county, which is adjacent to the annex. Half the roof, minus some metal work and gravel surfacing, is complete. Workers are finishing up the second half this week.

Phil Engle, senior roofing and waterproofing consultant, said work was delayed somewhat when workers ran into bad decking. Crews also had problems at the elections office because of a leak, which

has since been straightened out. Remaining repairs are on hold due to a back order in materials.

Engle reported repairs to the main courthouse are complete, absent some small metal work that should be finished in coming weeks. Still, that is not to say workers did not run into any hitches with the project.

In December, workers accidentally dripped burning tar into a wall on the north side of a fourth floor office while using a torch to repair and re-tar the roof of the county courthouse.

Mount Pleasant firefighters were called out and had to tear the wall open in order to extinguish the fire.

Cole Hafner, vice president of Hester Roofing, the company handling the county's roof project, estimated damage to the building. **See Roofing, Pg. 3A**

ADDITIONAL APPOINTMENTS - TUDS C.H.R.

PAT ADAMS

JUDY HAMMONDS

ROSEMARY HOBBS

BETTY HOLLINGSWORTH

DIANE KENNEDY

BILLY JOE LINDSEY

SHARON PALMER

JANET RUSSELL

PATRICIA ANTONELLI



RECEIVED

TITUS COUNTY JUDGE

Smith County  
Jeff Austin, III  
Chairman

Gregg County  
Linda Ryan Thomas  
Vice Chairman

Board Members

Bowie County  
Robert Murray

Cass County  
Open

Cherokee County  
Barry Hughes

Gregg County  
Keith Honey

Dave Spurrier

Harrison County  
Gaylon White

Panola County  
Walta Cooke

Rusk County  
John Cloutier

Smith County  
Tab Beall

Gary Halbrooks

Jeff Warr

Titus County  
Hudson Old

Upshur County  
David Stevenson

Van Zandt County  
Bill Rowton

Wood County  
Celia Boswell

January 18, 2008

Honorable Sam Russell  
County Judge, Titus County  
100 W. First Street, Ste. 200  
Mt. Pleasant, TX 75455

Dear Judge Russell,

This letter is to inform you that Titus County Board Member Hudson Old's term on the NET RMA Board of Directors will expire on February 1, 2008.

Per statute, Mr. Old may be reappointed by the Commissioners' Court if it so desires. Please contact Mr. Old to discuss his intentions as they pertain to the NET RMA. If Titus County chooses to appoint a new board member, please notify me as soon as possible so that we may begin the initiation process, including the completion of conflict of interest forms.

Please feel free to contact me if you have any questions. I thank you for your support of the NET RMA and look forward to our continued partnership.

Sincerely,

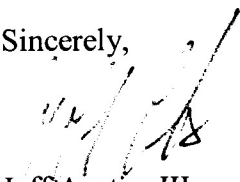

Jeff Austin, III  
Chairman

*Trust*

I, Judy Cook, Tax Collector for Titus County and the State of Texas, do solemnly swear that the above statement of collections made by me and the deposition thereof during the month of December 2007 is true and correct.

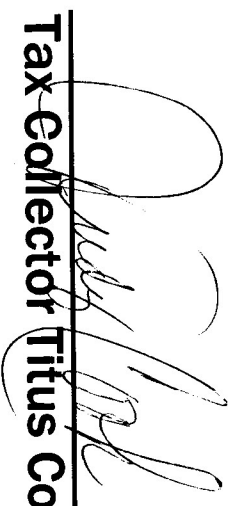

Tax Collector Titus County, Texas

**RECEIVED**

TITUS COUNTY JUDGE

	REFUND PI ONLY.	REFUND PI ONLY.	REFUND PI ONLY.
DUE TO AGENCY .	940.00		
DUE TO ATTY . . .	.00	REFUND LEVY/PI . .	.00
DUE TO ABST . . .	.00	REFUND ABST . . .	.00
DUE TO COURTS . .	.00	REFUND COURTS . .	.00
DUE TO OTHER . . .	.00	REFUND OTHER . . .	.00
DUE TOT REN PEN	.00	REF TOT REN PEN	.00
(AGENCY PART)	.00	(AGENCY PART)	.00
(CAD PART)	.00	(CAD PART)	.00

CURRENT		DELINQUENT		OTHER	
LEVY	130,502.14	LEVY	1,724.22	ATTY FEES	356.47
DISCOUNT	.00	PENALTY	209.14	COURT COST	.00
PENALTY	.00	INTEREST	428.19	ABST FEES	.00
INTEREST	.00			OTHER FEES	.00
				TOTAL REND PEN	68.98
				(AGENCY PART)	.00
				(CAD PART)	.00
LESS FEES	2,610.13-	LESS FEES	47.22-	TOTAL	425.45
TOTAL	127,892.01	TOTAL	2,314.33		
M&O LEVY	94,944.23	M&O LEVY	1,172.14		
M&O DISCOUNT	.00	M&O PENALTY	142.26		
M&O PENALTY	.00	M&O INTEREST	295.79		
M&O INTEREST	.00	LESS FEES	47.22-		
LESS FEES	2,610.13-	M&O TOTAL	1,562.97		
M&O TOTAL	92,334.10	I&S LEVY	552.08		
I&S LEVY	35,557.91	I&S DISCOUNT	.00		
I&S DISCOUNT	.00	I&S PENALTY	66.88		
I&S PENALTY	.00	I&S INTEREST	132.40		
I&S INTEREST	.00	I&S TOTAL	751.36		
I&S TOTAL	35,557.91				
TOTAL M&O	93,897.07	REF LEVY/PI(MO)	442.49-	REF LEVY/PI(1S)	165.73-
TOTAL I&S	36,309.27	REFUND PI ONLY	2.69-	REFUND PI ONLY	608.22-
FEES WITHHELD	2,657.35-	REFUND LEVY/PI	1.74-	REFUND ATTY	.00
		REFUND ABST	.00	REFUND COURTS	.00
		REFUND OTHER	.00	REFUND OTHER	.00
		REF TOT REND PEN	.00	REF TOT REND PEN	.00
		(AGENCY PART)	.00	(AGENCY PART)	.00
		(CAD PART)	.00	(CAD PART)	.00
DUE TO AGENCY	130,206.34	RET CHK PI ONLY	1.50-	RET CHK LEVY/PI	181.71-
DUE TO ATTY	356.47	RET CHK ATTY	.00	RET CHK ABST	.00
DUE TO ABST	.00	RET CHK COURTS	.00	RET CHK OTHER	.00
DUE TO COURTS	.00	RCK TOT REND PEN	9.44-	(AGENCY PART)	.00
DUE TO OTHER	.00	(CAD PART)	.00		
DUE TOT REND PEN	68.98				
(AGENCY PART)	.00				
(CAD PART)	.00				





YEAR	M&O	M&O	M&O	I&S	I&S	I&S	TOTAL	ATTY	GRAND
	LEVY	PENALTY	INTEREST	LEVY	PENALTY	INTEREST	TAXES	FEEES	TOTAL
2007	94,944.23	.00	.00	35,557.91	.00	.00	130,502.14	.00	130,502.14
2006	768.58	93.77	85.91	339.25	41.38	37.91	1,256.80	207.24	1,574.04
2005	124.06	14.91	28.68	62.71	7.49	14.50	232.25	37.86	290.21
2004	104.24	12.51	36.57	56.66	6.78	19.89	236.65	35.50	272.15
2003	63.59	7.64	30.00	35.75	4.29	16.87	159.14	23.72	181.86
2002	42.69	5.11	25.28	26.17	3.16	15.51	117.92	17.70	132.62
2001	28.40	3.41	20.28	17.43	2.09	12.43	84.04	12.60	96.64
2000	8.48	1.01	7.13	5.78	.70	4.87	27.97	4.19	32.16
1999	1.85	.23	1.76	1.38	.16	1.31	6.69	1.01	7.70
1998	3.04	.37	3.30	2.44	.29	2.64	12.08	1.81	13.89
1997	1.76	.22	2.09	1.45	.17	1.73	7.42	1.12	8.54
1996	2.47	.30	3.24	.71	.09	.93	7.74	1.16	8.90
1995	.00	.00	.00	.00	.00	.00	.00	.00	.00
1994	1.89	.23	2.92	1.09	.13	1.70	7.96	1.19	9.15
1993	1.72	.21	2.87	1.26	.15	2.11	8.32	1.25	9.57
1992	1.49	.18	2.67	.00	.00	.00	4.34	.65	4.99
1991	1.49	.18	2.85	.00	.00	.00	4.52	.68	5.20
1990	1.49	.18	3.02	.00	.00	.00	4.69	.70	5.39
1989	1.49	.18	3.20	.00	.00	.00	4.87	.73	5.60
1988	1.49	.18	3.38	.00	.00	.00	5.05	.76	5.81
1987	1.49	.18	7.12	.00	.00	.00	10.46	1.57	12.03
1986	2.98	.36	7.48	.00	.00	.00	10.82	1.62	12.44
1985	2.98	.36	7.84	.00	.00	.00	11.18	1.68	12.86
1984	2.98	.36	8.20	.00	.00	.00	11.54	1.73	13.27
1983	.00	.00	.00	.00	.00	.00	.00	.00	.00
1982	.00	.00	.00	.00	.00	.00	.00	.00	.00
1981	.00	.00	.00	.00	.00	.00	.00	.00	.00
1980	.00	.00	.00	.00	.00	.00	.00	.00	.00
1979	.00	.00	.00	.00	.00	.00	.00	.00	.00
PRIOR	.00	.00	.00	.00	.00	.00	.00	.00	.00
TOTAL	96,116.37	142.26	295.79	36,109.99	66.88	132.40	132,863.69	356.47	133,220.16

CURRENT		DELINQUENT		OTHER	
LEVY	427,407.98	LEVY	7,217.42	ATTY FEES	.00
DISCOUNT	4,833.24	PENALTY	879.26	COURT COST	.00
PENALTY	.34	INTEREST	1,479.27	ABST FEES	.00
INTEREST	.00			OTHER FEES	.00
				TOTAL REND PEN	283.21
				(AGENCY PART)	283.21
				(CAD PART)	.00
LESS FEES	8,451.74	LESS FEES	478.89	TOTAL	283.21
TOTAL	414,123.34	TOTAL	9,097.06		
M&O LEVY	288,380.75	M&O LEVY	5,231.27		
M&O DISCOUNT	3,260.98	M&O PENALTY	636.82		
M&O PENALTY	.25	M&O INTEREST	1,110.79		
M&O INTEREST	.00	LESS FEES	478.89		
LESS FEES	8,451.74	M&O TOTAL	6,499.99		
M&O TOTAL	276,668.28	I&S LEVY	1,986.15		
I&S LEVY	139,027.23	I&S DISCOUNT	1,572.26		
I&S DISCOUNT	1,572.26	I&S PENALTY	242.44		
I&S PENALTY	.00	I&S INTEREST	368.48		
I&S INTEREST	.00	I&S TOTAL	2,597.07		
I&S TOTAL	137,455.06				
TOTAL M&O	283,168.27				
TOTAL I&S	140,052.13				
FEES WITHHELD	8,930.63				
		REF LEVY/PI(MO)	2,128.47	RET CHK PI ONLY	2.52
		REF LEVY/PI(1S)	1,026.14	RET CHK LEVY/PI	638.19
		REFUND PI ONLY	73.62	RET CHK ATTY	.00
		REFUND LEVY/PI	3,154.61	RET CHK ABST	.00
		REFUND ATTY	.00	RET CHK COURTS	.00
		REFUND ABST	.00	RET CHK OTHER	.00
		REFUND COURTS	.00	RCK TOT REND PEN	34.99
		REFUND OTHER	.00	(AGENCY PART)	.00
		REF NOT REND PEN	.00	(CAD PART)	.00
		(AGENCY PART)	.00		
		(CAD PART)	.00		
DUE TO AGENCY	423,220.40				
DUE TO ATTY	.00				
DUE TO ABST	.00				
DUE TO COURTS	.00				
DUE TO OTHER	.00				
DUE TOT REND PEN	283.21				
(AGENCY PART)	283.21				
(CAD PART)	.00				



YEAR	M&O	M&O	M&O	I&S	I&S	I&S	TOTAL	ATTY	GRAND
	LEVY	PENALTY	LEVY	PENALTY	INTEREST	TAXES	FEEES	TOTAL	
2007	288,380.75	3,260.73	.00	139,027.23	1,572.17	184.88	422,575.08	.00	422,575.08
2006	3,252.16	329.34	366.43	1,640.89	201.45	6,045.17	6,045.17	.00	6,045.17
2005	1,024.32	122.90	236.47	170.40	20.47	39.29	1,613.45	.00	1,613.45
2004	448.61	32.83	157.37	76.32	9.17	28.80	772.10	.00	772.10
2003	221.25	26.56	124.36	30.29	3.63	14.29	400.38	.00	400.38
2002	105.27	12.64	62.47	15.94	1.91	207.69	207.69	.00	207.69
2001	89.01	10.68	63.49	14.96	1.79	190.61	190.61	.00	190.61
2000	30.05	3.60	23.24	5.74	.69	70.16	70.16	.00	70.16
1999	6.85	.83	6.52	1.50	.17	17.29	17.29	.00	17.29
1998	11.61	1.40	12.57	2.57	.31	31.24	31.24	.00	31.24
1997	6.86	.83	8.16	1.50	.18	19.31	19.31	.00	19.31
1996	5.64	.67	7.39	2.26	.27	19.19	19.19	.00	19.19
1995	.00	.00	.00	.00	.00	17.43	17.43	.00	17.43
1994	5.26	.63	8.15	1.27	.15	19.11	19.11	.00	19.11
1993	5.47	.65	9.13	1.38	.17	6.89	6.89	.00	6.89
1992	2.34	.28	3.97	.03	.00	6.39	6.39	.00	6.39
1991	2.08	.25	4.20	.03	.00	6.61	6.61	.00	6.61
1990	2.07	.25	4.20	.03	.00	6.02	6.02	.00	6.02
1989	.00	.00	.00	1.84	.22	4.59	6.88	.00	6.88
1988	.01	.00	.02	2.02	.24	6.88	15.38	.00	15.38
1987	4.13	.50	9.86	.25	.61	15.57	15.57	.00	15.57
1986	4.13	.49	10.36	.16	.41	16.08	16.08	.00	16.08
1985	4.13	.49	10.85	.16	.43	16.60	16.60	.00	16.60
1984	.00	.00	.00	4.29	.51	.00	.00	.00	.00
1983	.00	.00	.00	.00	.00	.00	.00	.00	.00
1982	.00	.00	.00	.00	.00	3.73	3.73	.00	3.73
1981	.00	.00	.00	.88	.11	2.74	4.05	.00	4.05
1980	.00	.00	.00	.95	.08	3.02	4.10	.00	4.10
1979	.00	.00	.00	.08	.08	3.07	4.10	.00	4.10
PRIOR	.00	.00	.00	9.54	.77	34.21	44.52	.00	44.52

TOTAL	293,612.02	2,623.91	1,110.79	141,013.38	1,329.73	368.48	432,151.03	.00	432,151.03
-------	------------	----------	----------	------------	----------	--------	------------	-----	------------

CURRENT		DELINQUENT		OTHER	
LEVY	170,210.69	LEVY	3,223.51	ATTY FEES	.00
DISCOUNT	1,921.35	PENALTY	391.87	COURT COST	.00
PENALTY	.00	INTEREST	700.76	ABST FEES	.00
INTEREST	.00			OTHER FEES	.00
				TOTAL REND PEN.	109.82
				(AGENCY PART)	109.82
				(CAD PART)	.00
LESS FEES	3,365.85	LESS FEES	86.25	TOTAL	109.82
TOTAL	164,923.49	TOTAL	4,229.89		
M&O LEVY	90,313.98	M&O LEVY	1,768.64		
M&O DISCOUNT	1,020.47	M&O PENALTY	214.86		
M&O INTEREST	.00	M&O INTEREST	448.07		
LESS FEES	3,365.85	LESS FEES	86.25		
M&O TOTAL	85,927.66	M&O TOTAL	2,345.32		
I&S LEVY	79,896.71	I&S LEVY	1,454.87		
I&S DISCOUNT	900.88	I&S PENALTY	177.01		
I&S INTEREST	.00	I&S INTEREST	252.69		
I&S TOTAL	78,995.83	I&S TOTAL	1,884.57		
TOTAL M&O	88,272.98				
TOTAL I&S	80,880.40				
FEES WITHHELD	3,452.10				
		REF LEVY/PI(MO)	526.67	RET CHK PI ONLY	.85
		REF LEVY/PI(S)	465.94	RET CHK LEVY/PI	246.69
		REFUND PI ONLY	21.35	RET CHK ABST	.00
		REFUND LEVY/PI	992.61	RET CHK COURTS	.00
		REFUND ATTY	.00	RET CHK OTHER	.00
		REFUND ABST	.00	RCY TOT REND PEN	13.49
		REFUND COURTS	.00	(AGENCY PART)	.00
		REFUND OTHER	.00	(CAD PART)	.00
		REF TOT REND PEN	.00		
		(AGENCY PART)	.00		
		(CAD PART)	.00		
DUE TO AGENCY	169,153.38				
DUE TO ATTY	.00				
DUE TO ABST	.00				
DUE TO COURTS	.00				
DUE TO OTHER	.00				
DUE TOT REND PEN	109.82				
(AGENCY PART)	109.82				
(CAD PART)	.00				



YEAR	MEO	MEO	MEO	IS	IS	IS	TOTAL	ATTY	GRAND
	LEVY	PENALTY	INTEREST	LEVY	PENALTY	INTEREST	TAXES	FEES	TOTAL
2007	90,313.98	1,020.47-	.00	79,971.91	900.88-	.00	168,289.34	.00	168,289.34
2006	1,027.64	126.04	115.78	119.43	119.43	109.50	2,470.00	.00	2,470.00
2005	343.57	41.20	79.19	324.91	39.07	75.02	903.55	.00	903.55
2004	159.50	19.12	55.95	150.71	18.10	52.88	456.26	.00	456.26
2003	83.96	10.08	39.61	.00	.00	.00	133.65	.00	133.65
2002	43.11	5.17	25.59	.00	.00	.00	73.87	.00	73.87
2001	50.74	6.07	36.17	.00	.00	.00	92.98	.00	92.98
2000	14.56	1.75	12.24	.00	.00	.00	28.55	.00	28.55
1999	3.73	.44	3.55	.00	.00	.00	7.72	.00	7.72
1998	6.35	.75	6.87	.00	.00	.00	13.97	.00	13.97
1997	3.74	.44	4.46	.00	.00	.00	8.64	.00	8.64
1996	.10	.01	.13	3.60	.43	4.72	8.99	.00	8.99
1995	.00	.00	.00	.00	.00	.00	.00	.00	.00
1994	3.54	.42	5.49	.00	.00	.00	9.45	.00	9.45
1993	3.30	.40	5.51	.00	.00	.00	9.21	.00	9.21
1992	2.62	.31	4.69	.00	.00	.00	7.62	.00	7.62
1991	2.62	.31	5.00	.00	.00	.00	7.93	.00	7.93
1990	2.61	.31	5.30	.00	.00	.00	8.22	.00	8.22
1989	1.41	.17	3.03	.00	.00	.00	4.61	.00	4.61
1988	1.63	.20	3.70	.00	.00	.00	5.53	.00	5.53
1987	3.33	.40	7.96	.00	.00	.00	11.69	.00	11.69
1986	3.42	.41	8.58	.00	.00	.00	12.41	.00	12.41
1985	3.58	.43	9.42	.00	.00	.00	13.43	.00	13.43
1984	3.58	.43	9.85	.00	.00	.00	13.86	.00	13.86
1983	.00	.00	.00	.00	.00	.00	.00	.00	.00
1982	.00	.00	.00	.00	.00	.00	.00	.00	.00
1981	.00	.00	.00	.35	.04	1.09	1.48	.00	1.48
1980	.00	.00	.00	.35	.03	1.11	1.49	.00	1.49
1979	.00	.00	.00	.35	.03	1.13	1.51	.00	1.51
PRIOR	.00	.00	.00	2.10	.18	7.24	9.52	.00	9.52
TOTAL	92,082.62	805.61-	448.07	81,351.58	723.87-	253.69	172,605.48	.00	172,605.48



----- CURRENT -----		----- DELINQUENT -----		----- OTHER -----	
LEVY .....	.00	LEVY .....	.85	ATTY FEES .....	.00
DISCOUNT .....	.00	PENALTY .....	.09	COURT COST .....	.00
PENALTY .....	.00	INTEREST .....	3.12	ABST FEES .....	.00
INTEREST .....	.00	LESS FEES .....	.22-	OTHER FEES .....	.00
LESS FEES .....	.00	TOTAL .....	3.84	TOTAL .....	.00
TOTAL .....	.00	M&O LEVY .....	.00		
M&O DISCOUNT .....	.00	M&O PENALTY .....	.00		
M&O PENALTY .....	.00	M&O INTEREST .....	.00		
M&O INTEREST .....	.00	LESS FEES .....	.22-		
LESS FEES .....	.00	M&O TOTAL .....	.22-		
M&O TOTAL .....	.00	I&S LEVY .....	.85		
I&S LEVY .....	.00	I&S DISCOUNT .....	.00		
I&S DISCOUNT .....	.00	I&S PENALTY .....	.09		
I&S PENALTY .....	.00	I&S INTEREST .....	3.12		
I&S INTEREST .....	.00	I&S TOTAL .....	4.06		
I&S TOTAL .....	.00				
TOTAL M&O .....	.22-				
TOTAL I&S .....	4.06				
FEES WITHHELD .....	.22-				
		REFUND PI ONLY .....	.00	RET CHK PI ONLY .....	.00
DUE TO AGENCY .....	3.84	REFUND LEVY/PI .....	.00	RET CHK LEVY/PI .....	.00
DUE TO ATTY .....	.00	REFUND ATTY .....	.00	RET CHK ATTY .....	.00
DUE TO ABST .....	.00	REFUND ABST .....	.00	RET CHK ABST .....	.00
DUE TO COURTS .....	.00	REFUND COURTS .....	.00	RET CHK COURTS .....	.00
DUE TO OTHER .....	.00	REFUND OTHER .....	.00	RET CHK OTHER .....	.00
DUE TOT REM PEN .....	.00	REF TOT REM PEN .....	.00	RCK TOT REM PEN .....	.00
(AGENCY PART) .....	.00	(AGENCY PART) .....	.00	(AGENCY PART) .....	.00
(CAD PART) .....	.00	(CAD PART) .....	.00	(CAD PART) .....	.00



YEAR	M&O LEVY	M&O PENALTY	M&O INTEREST	ISS LEVY	ISS PENALTY	ISS INTEREST	TOTAL TAXES	ATTY FEES	GRAND TOTAL
2007	.00	.00	.00	.00	.00	.00	.00	.00	.00
2006	.00	.00	.00	.00	.00	.00	.00	.00	.00
2005	.00	.00	.00	.00	.00	.00	.00	.00	.00
2004	.00	.00	.00	.00	.00	.00	.00	.00	.00
2003	.00	.00	.00	.00	.00	.00	.00	.00	.00
2002	.00	.00	.00	.00	.00	.00	.00	.00	.00
2001	.00	.00	.00	.00	.00	.00	.00	.00	.00
2000	.00	.00	.00	.00	.00	.00	.00	.00	.00
1999	.00	.00	.00	.00	.00	.00	.00	.00	.00
1998	.00	.00	.00	.00	.00	.00	.00	.00	.00
1997	.00	.00	.00	.00	.00	.00	.00	.00	.00
1996	.00	.00	.00	.00	.00	.00	.00	.00	.00
1995	.00	.00	.00	.00	.00	.00	.00	.00	.00
1994	.00	.00	.00	.00	.00	.00	.00	.00	.00
1993	.00	.00	.00	.00	.00	.00	.00	.00	.00
1992	.00	.00	.00	.00	.00	.00	.00	.00	.00
1991	.00	.00	.00	.00	.00	.00	.00	.00	.00
1990	.00	.00	.00	.00	.00	.00	.00	.00	.00
1989	.00	.00	.00	.00	.00	.00	.00	.00	.00
1988	.00	.00	.00	.00	.00	.00	.00	.00	.00
1987	.00	.00	.00	.00	.00	.00	.00	.00	.00
1986	.00	.00	.00	.00	.00	.00	.00	.00	.00
1985	.00	.00	.00	.00	.00	.00	.00	.00	.00
1984	.00	.00	.00	.00	.00	.00	.00	.00	.00
1983	.00	.00	.00	.00	.00	.00	.00	.00	.00
1982	.00	.00	.00	.00	.00	.00	.00	.00	.00
1981	.00	.00	.00	.00	.00	.00	.00	.00	.00
1980	.00	.00	.00	.00	.00	.00	.00	.00	.00
1979	.00	.00	.00	.07	.01	.23	.31	.00	.31
PRIOR	.00	.00	.00	.78	.08	2.89	3.75	.00	3.75
TOTAL	.00	.00	.00	.85	.09	3.12	4.06	.00	4.06

----- CURRENT ----- DELINQUENT ----- OTHER -----

LEVY .....	.00	LEVY .....	3.74	ATTY FEES .....	.00
DISCOUNT .....	.00	PENALTY .....	.37	COURT COST .....	.00
PENALTY .....	.00	INTEREST .....	11.34	ABST FEES .....	.00
INTEREST .....	.00	LESS FEES .....	.13-	OTHER FEES .....	.00
LESS FEES .....	.00	TOTAL .....	15.32	TOTAL .....	.00
TOTAL .....	.00	M&O LEVY .....	.00		
M&O LEVY .....	.00	M&O DISCOUNT .....	.00		
M&O DISCOUNT .....	.00	M&O PENALTY .....	.00		
M&O PENALTY .....	.00	M&O INTEREST .....	.00		
M&O INTEREST .....	.00	LESS FEES .....	.13-		
LESS FEES .....	.00	M&O TOTAL .....	.13-		
M&O TOTAL .....	.00	I&S LEVY .....	3.74		
I&S LEVY .....	.00	I&S DISCOUNT .....	.00		
I&S DISCOUNT .....	.00	I&S PENALTY .....	.37		
I&S PENALTY .....	.00	I&S INTEREST .....	11.34		
I&S INTEREST .....	.00	I&S TOTAL .....	15.45		
I&S TOTAL .....	.00				

TOTAL M&O .....	.13-				
TOTAL I&S .....	15.45				
FEES WITHHELD..	.13-				

REFUND PI ONLY.	.00	REFUND LEVY/PI ..	.00	RET CHK LEVY/PI ..	.00
		REFUND ATTY .....	.00	RET CHK ATTY .....	.00
		REFUND ABST .....	.00	RET CHK ABST .....	.00
		REFUND COURTS ..	.00	RET CHK COURTS ..	.00
		REFUND OTHER ..	.00	RET CHK OTHER ..	.00
		REF TOT REN PEN	.00	RCK TOT REN PEN	.00
		(AGENCY PART)	.00	(AGENCY PART)	.00
		(CAD PART)	.00	(CAD PART)	.00

DUE TO AGENCY .	15.32				
DUE TO ATTY ...	.00				
DUE TO ABST ...	.00				
DUE TO COURTS .	.00				
DUE TO OTHER ..	.00				
DUE TOT REN PEN	.00				
(AGENCY PART)	.00				
(CAD PART)	.00				



YEAR	M&O	PENALTY	INTEREST	ISS	PENALTY	INTEREST	TOTAL	ATTY	GRAND
	LEVY	LEVY	LEVY	LEVY	LEVY	LEVY	TAXES	FEEES	TOTAL
2007	.00	.00	.00	.00	.00	.00	.00	.00	.00
2006	.00	.00	.00	.00	.00	.00	.00	.00	.00
2005	.00	.00	.00	.00	.00	.00	.00	.00	.00
2004	.00	.00	.00	.00	.00	.00	.00	.00	.00
2003	.00	.00	.00	.00	.00	.00	.00	.00	.00
2002	.00	.00	.00	.00	.00	.00	.00	.00	.00
2001	.00	.00	.00	.00	.00	.00	.00	.00	.00
2000	.00	.00	.00	.00	.00	.00	.00	.00	.00
1999	.00	.00	.00	.00	.00	.00	.00	.00	.00
1998	.00	.00	.00	.00	.00	.00	.00	.00	.00
1997	.00	.00	.00	.00	.00	.00	.00	.00	.00
1996	.00	.00	.00	.00	.00	.00	.00	.00	.00
1995	.00	.00	.00	.00	.00	.00	.00	.00	.00
1994	.00	.00	.00	.00	.00	.00	.00	.00	.00
1993	.00	.00	.00	.00	.00	.00	.00	.00	.00
1992	.00	.00	.00	.00	.00	.00	.00	.00	.00
1991	.00	.00	.00	.00	.00	.00	.00	.00	.00
1990	.00	.00	.00	.00	.00	.00	.00	.00	.00
1989	.00	.00	.00	.00	.02	.32	.48	.00	.48
1988	.00	.00	.00	.14	.04	.76	1.12	.00	1.12
1987	.00	.00	.00	.32	.04	.76	1.63	.00	1.63
1986	.00	.00	.00	.45	.05	1.13	1.68	.00	1.68
1985	.00	.00	.00	.45	.05	1.13	1.68	.00	1.68
1984	.00	.00	.00	.45	.05	1.13	1.74	.00	1.74
1983	.00	.00	.00	.00	.00	.00	.00	.00	.00
1982	.00	.00	.00	.00	.00	.00	.00	.00	.00
1981	.00	.00	.00	.07	.01	.22	.30	.00	.30
1980	.00	.00	.00	.07	.01	.22	.30	.00	.30
1979	.00	.00	.00	.09	.01	.29	.39	.00	.39
PRIOR	.00	.00	.00	1.70	.13	5.98	7.81	.00	7.81
TOTAL	.00	.00	.00	3.74	.37	11.34	15.45	.00	15.45

CURRENT		DELINQUENT		OTHER	
LEVY	728,120.81	LEVY	12,169.74	ATTY FEES	356.47
DISCOUNT	6,754.59	PENALTY	2,420.73	COURT COST	.00
PENALTY	.34	INTEREST	2,622.68	ABST FEES	.00
INTEREST	.00			OTHER FEES	.00
				TOTAL REND PEN	462.01
				(AGENCY PART)	.00
				(CAD PART)	.00
LESS FEES	14,427.72	LESS FEES	612.71	TOTAL	818.48
TOTAL	706,998.84	TOTAL	16,600.44		
M&O LEVY	473,638.96	M&O LEVY	8,172.05		
M&O DISCOUNT	.00	M&O PENALTY	993.94		
M&O PENALTY	.25	M&O INTEREST	1,854.65		
M&O INTEREST	.00	LESS FEES	612.71		
LESS FEES	14,427.72	M&O TOTAL	10,407.93		
M&O TOTAL	459,211.49	I&S LEVY	3,997.69		
I&S LEVY	254,481.85	I&S DISCOUNT	.00		
I&S DISCOUNT	.00	I&S PENALTY	1,426.79		
I&S PENALTY	.09	I&S INTEREST	768.03		
I&S INTEREST	.00	I&S TOTAL	6,192.51		
I&S TOTAL	254,481.94				
TOTAL M&O	469,619.42				
TOTAL I&S	260,674.45				
FEES WITHHELD	15,040.43				
DUE TO AGENCY	738,579.71	REFUND PI ONLY	92.28	RET CHK PI ONLY	1.87
DUE TO ATTY	356.47	REND LEVY/PI	4,755.44	RET CHK LEVY/PI	1,066.59
DUE TO ABST	.00	REFUND ABST	1.74	RET CHK ATTY	1.20
DUE TO COURTS	.00	REFUND COURTS	.00	RET CHK ABST	.00
DUE TO OTHER	.00	REFUND OTHER	.00	RET CHK COURTS	.00
DUE TOT REN PEN	462.01	REF TOT REN PEN	.00	RET CHK OTHER	.00
(AGENCY PART)	462.01	(AGENCY PART)	.00	RCK TOT REN PEN	57.92
(CAD PART)	.00	(CAD PART)	.00	(AGENCY PART)	.00

AGENCY	COLLECTED	FEES	DUE TO JURISDICTION
CERT	940.00		940.00
COLL	132,863.69	2,657.35-	130,206.34
	TOTAL REND PEN		
	(AGENCY PART)	68.98	
	(CAD PART)	68.98	
		.00	
COUN	432,151.03	8,930.63-	423,220.40
	TOTAL REND PEN		
	(AGENCY PART)	283.21	
	(CAD PART)	.00	
HOSP	172,605.48	3,452.10-	169,153.38
	TOTAL REND PEN		
	(AGENCY PART)	109.82	
	(CAD PART)	109.82	
		4.06	
ST	4.06	.22-	3.84
WATR	5.45	.13-	15.32
ATTY FEES	356.47		
REFUNDS	4,757.18		
* TOTAL	744,155.37	15,040.43-	729,114.94
HOT CHECKS	1,067.79		



CERT	.00
COLL	356.47
COUN	.00
HOSP	.00
ST	.00
WATR	.00
* TOTAL	356.47

JURISDICTION	LEVY COLLECTED	DISCOUNT/PAI COLLECTED	ATTORNEY FEES COLLECTED	OTHER FEES COLLECTED	REFUNDS/NSF CKS	COLLECTION FEES WITHHELD	TOTAL AMOUNT TO DISBURSE
CERTIFICATE	.00	940.00	.00	.00	.00	.00	940.00
N.E.T.COMMUNITY COLL	133,002.66	641.52	359.41	78.42	792.87-	2,657.35-	130,631.79
TITUS COUNTY	438,459.35	2,550.51-	.00	318.20	3,792.80-	8,930.65-	423,503.61
MEMORIAL HOSP. DIST.	174,682.21	850.92-	.00	123.31	1,239.30-	3,452.10-	169,263.20
STATE	.85	3.21	.00	.00	.00	.22-	3.84
WATER DISTRICT	3.74	11.71	.00	.00	.00	.13-	15.32
* TOTAL	746,148.81	1,804.99-	359.41	519.93	5,824.97-	15,040.43-	724,357.76

JURISDICTION	ZONE	CURRENT LEVY COLLECTED	DELINQUENT LEVY COLLECTED
* TOTAL		.00	.00

TALOCER RUN:01/25/2008 14:55 BY AGENCY

	GROSS			RETURNS			NET CHECKS			NET		
	LEVY	FEI	TOTAL	LEVY	FEI	TOTAL	LEVY	FEI	TOTAL	LEVY	FEI	TOTAL
CERT CURR	.00	.00	.00	.00	.00	.00	.00	.00	.00	.00	.00	.00
DEIQ	.00	.00	.00	.00	.00	.00	.00	.00	.00	.00	.00	.00
TOT	.00	.00	.00	.00	.00	.00	.00	.00	.00	.00	.00	.00
COLL CURR	131,215.34	.00	131,215.34	548.95-	.00	548.95-	164.25-	.00	164.25-	130,502.14	.00	130,502.14
DEIQ	1,787.32	641.52	2,428.84	56.58-	2.69-	59.27-	6.52-	1.50-	8.02-	1,724.22	637.33	2,361.55
TOT	133,002.66	641.52	133,644.18	605.53-	2.69-	608.22-	170.77-	1.50-	172.27-	132,226.36	637.33	132,863.69
COUN CURR	431,014.66	4,922.44-	426,092.22	3,024.12-	81.69	2,942.43-	582.56-	7.85	574.71-	427,407.98	4,832.90-	422,575.08
DEIQ	7,444.69	2,371.93	9,816.62	204.11-	8.07-	212.18-	23.16-	5.33-	28.49-	7,217.42	2,358.53	9,575.95
TOT	438,459.35	2,550.51-	435,908.84	3,228.23-	73.62	3,154.61-	605.72-	2.52	603.20-	434,625.40	2,474.37-	432,151.03
HOSP CURR	171,365.84	1,949.41-	169,416.43	930.56-	25.03	905.53-	224.59-	3.03	221.56-	170,210.69	1,921.35-	168,289.34
DEIQ	3,316.37	1,098.49	4,414.86	83.40-	3.69-	87.09-	9.46-	2.18-	11.64-	3,223.51	1,092.63	4,316.14
TOT	174,682.21	850.92-	173,831.29	1,013.96-	21.35	992.61-	234.05-	.85	233.20-	173,434.20	828.72-	172,605.48
ST CURR	.00	.00	.00	.00	.00	.00	.00	.00	.00	.00	.00	.00
DEIQ	.85	3.21	4.06	.00	.00	.00	.00	.00	.00	.85	3.21	4.06
TOT	.85	3.21	4.06	.00	.00	.00	.00	.00	.00	.85	3.21	4.06
WATER CURR	.00	.00	.00	.00	.00	.00	.00	.00	.00	.00	.00	.00
DEIQ	3.74	11.71	15.45	.00	.00	.00	.00	.00	.00	3.74	11.71	15.45
TOT	3.74	11.71	15.45	.00	.00	.00	.00	.00	.00	3.74	11.71	15.45
ACTY			359.41			1.74-			1.20-			356.47
FUND			519.93			.00			57.92-			462.01
TOTL			745,223.16			4,757.18-			1,067.79-			739,398.19

	ORIGINAL	SUPPLEMENTAL	TOTAL CURRENT	% PAID	DELINQUENT	% PAID	SUMMARY	
LEVY	BEGIN 8,724,944.35	.00	8,724,944.35		404,890.12		9,129,834.47	
LATE HS/65	4,224.36-	.00	4,224.36-		69.62-		4,293.98-	
OTHER ADJUSTMENTS	30,862.39-	.00	30,862.39-		877.18-		31,739.57-	
SUPPLEMENTS	.00	6,182.56	6,182.56		.00		6,182.56	
ADJUSTED	8,689,857.60	6,182.56	8,696,040.16		403,943.32		9,099,983.48	
COLLECTED	6,010,980.64-	202.87-	6,011,183.51-	69.12	32,587.66-	8.06	6,043,771.17-	
PR YR REF/NSF CHK	.00	.00	.00		1,982.47-		1,982.47-	
UNCOLLECTED	2,678,876.96-	5,979.69-	2,684,856.65-		369,373.19-		3,054,229.84-	
LATE RENDITION BEGIN	5,533.68	.00	5,533.68		946.63		6,480.31	
LATE REND ADJUSTED	4,739.26	.00	4,739.26		943.25		5,682.51	
COLLECTED	LEVY 6,010,980.64	202.87	6,011,183.51	69.12	32,587.66	8.06	6,043,771.17	
DISCOUNTS	165,952.29-	2.54-	165,954.83-		17.80		165,937.03-	
PENALTY	5.64	.00	5.64		4,062.43		4,068.07	
INTEREST	.00	.00	.00		6,876.25		6,876.25	
NET	5,845,033.99	200.33	5,845,234.32		43,544.14		5,888,778.46	
COURT COST	.00	.00	.00		.00		.00	
ABST FEES	.00	.00	.00		.00		.00	
APTY FEES	.00	.00	.00		.00		.00	
OTHER FEES	.00	.00	.00		.00		.00	
REND PENALTY	663.74	.00	663.74		118.53		782.27	
(AGENCY %)	663.74	.00	663.74		118.53		782.27	
(CAD %)	.00	.00	.00		.00		.00	
TOTAL	5,845,697.73	200.33	5,845,898.06		43,662.67		5,889,560.73	
ELIQUENT BREAKDOWN	BEGIN	ADJUSTMENTS	SUPPLEMENTS	ADJUSTED	COLLECTED	PRIOR YR REF	UNCOLLECTED	% PAID
2006 -	143,105.47	818.15-	.00	142,287.32	18,794.40-	1,982.47-	121,510.45-	13.20
2005 -	61,913.41	128.65-	.00	61,784.76	6,646.39-	.00	55,138.37-	10.75
2004 -	35,274.64	.00	.00	35,274.64	3,102.08-	.00	32,172.56-	8.79
2003 -	26,336.96	.00	.00	26,336.96	1,780.92-	.00	24,556.04-	6.76
2002 -	21,143.07	.00	.00	21,143.07	1,268.09-	.00	19,874.98-	5.99
2001 -	15,464.24	.00	.00	15,464.24	711.33-	.00	14,752.91-	4.59
2000 -	13,258.65	.00	.00	13,258.65	147.69-	.00	13,110.96-	1.11
1999 -	9,678.13	.00	.00	9,678.13	12.29-	.00	9,665.84-	0.12
1998 -	9,237.31	.00	.00	9,237.31	14.18-	.00	9,223.13-	0.15
1997 -	7,156.83	.00	.00	7,156.83	8.36-	.00	7,148.47-	0.11
1996 -	5,785.52	.00	.00	5,785.52	7.90-	.00	5,777.62-	0.13
1995 -	5,446.21	.00	.00	5,446.21	.00	.00	5,446.21-	0.00
1994 -	7,948.59	.00	.00	7,948.59	6.53-	.00	7,942.06-	0.08
1993 -	7,447.38	.00	.00	7,447.38	6.85-	.00	7,440.53-	0.09
1992 -	2,821.99	.00	.00	2,821.99	12.13-	.00	2,809.86-	0.42
1991 -	2,686.94	.00	.00	2,686.94	2.11-	.00	2,684.83-	0.07
1990 -	2,933.15	.00	.00	2,933.15	2.10-	.00	2,931.05-	0.07
1989 -	2,012.33	.00	.00	2,012.33	1.84-	.00	2,010.49-	0.09
1988 -	2,367.00	.00	.00	2,367.00	17.90-	.00	2,349.10-	0.75
1987 -	3,514.39	.00	.00	3,514.39	19.38-	.00	3,495.01-	0.55
1986 -	3,396.84	.00	.00	3,396.84	4.29-	.00	3,392.55-	0.12
1985 -	1,460.71	.00	.00	1,460.71	4.29-	.00	1,456.42-	0.29
1984 -	2,904.60	.00	.00	2,904.60	4.29-	.00	2,900.31-	0.14
1983 -	4,005.59	.00	.00	4,005.59	.00	.00	4,005.59-	0.00
1982 -	5,281.82	.00	.00	5,281.82	.00	.00	5,281.82-	0.00
1981 -	1,582.31	.00	.00	1,582.31	.00	.00	1,581.43-	0.05
1980 -	210.43	.00	.00	210.43	.00	.00	209.48-	0.45
1979 -	74.47	.00	.00	74.47	.00	.00	73.52-	1.27
1978 -	53.89	.00	.00	53.89	.00	.00	52.94-	1.76
PRIOR YEARS	387.25	.00	.00	387.25	8.59-	.00	378.66-	2.21

FUND NAME	CHECKING ACCOUNT	CHECKING AMOUNT	TDOA ACCOUNT	TDOA AMOUNT	FUND TOTAL
2008 010 GENERAL COUNTY FUND	MAIN	500.00			
	MAIN				
	MAIN	600.00			
	MAIN	2,500.00			
	MAIN				
	MAIN	400.00			
	CC PETTY				
	GF/JP#1				
	MAIN	1,592,180.33	<62,688.26> = 1,529,491.97		4,596,180.33
	TD-MAIN	3,000,000.00			
	GF JUVPROB				
	INVT-MAIN				
2008 016 SECURITY FEES FUND	MAIN	127,201.80			127,201.80
2008 017 JURY FUND	MAIN	46,509.97	<1,880.00> = 44,629.97		46,509.97
2008 018 LAW LIBRARY FUND	MAIN	15,090.95			15,090.95
2008 019 EMPLOYEE FLOWER FUND	MAIN	1,050.99			1,050.99
2008 021 ROAD & BRIDGE #1 FUND	MAIN	454,902.12	<11,104.66> = 443,797.46		454,902.12
2008 022 ROAD & BRIDGE #2 FUND	MAIN	156,085.49	<914.16> = 155,171.33		156,085.49
2008 023 ROAD & BRIDGE #3 FUND	MAIN	199,300.15	<7,868.26> = 191,431.89		199,300.15
2008 024 ROAD & BRIDGE #4 FUND	MAIN	683,052.25			683,052.25
2008 026 CHAPTER 19: FY 2005	MAIN				
2008 027 CHAPTER 19: FY 2003	MAIN	47.70			47.70
2008 028 JUSTICE COURT TECHNOLOGY	MAIN	23,521.39			23,521.39
2008 029 JUSTICE COURT TECHNOLOGY-JP2MAIN	MAIN	19,537.34			19,537.34
2008 031 PARK FUND	MAIN	150.00			150.00
	MAIN	4,647.13	<581.40> = 4,065.73		4,797.13
2008 032 TITUS CTY HISTORICAL SOCIETYMAIN	MAIN	1,643.42			1,643.42
2008 040 HOMELAND SECURITY 2005	MAIN				
2008 041 VICTIM OF CRIME FUND	MAIN	180,260.39			180,260.39
2008 042 CRIMINAL JUSTICE FUND	MAIN	160.21			160.21
2008 043 COUNTY CLERK R&M FUND	MAIN	258,086.93			258,086.93
2008 044 DISTRICT CLERK R&M FUND	MAIN	12,115.98			12,115.98
2008 045 HOMELAND SECURITY 2004-2005	MAIN				
2008 046 TEXAS VINE GRANT	MAIN	6,739.00			6,739.00

FUND NAME	CHECKING ACCOUNT	CHECKING AMOUNT	TDOA ACCOUNT	TDOA AMOUNT	FUND TOTAL
2008 047 DISTRICT ATTORNEY FUND	MAIN	4,157.67			4,157.67
2008 048 COUNTY ATTORNEY FUND	MAIN	28,287.81			28,287.81
2008 049 HOMELAND SECURITY GRANT	MAIN				
2008 050 VEHICLE INVENTORY TAX ACCOUNT	TAX ACCT	190,583.25			190,583.25
2008 052 TEXAS CAPITAL FUND ESCROW	FUTX CAP ESC TD-TXCAPES	20,280.84			425,280.84
2008 053 SHERIFF SEIZED ACCOUNT	SHERIFF	101,174.79			101,174.79
2008 054 DISTRICT ATTORNEY SEIZED ACCDA SEIZED		258,614.38			258,614.38
2008 055 DIST ATTY DRUG FORFEITURE PUFORFEITURE		133,650.76			133,650.76
2008 056 SHERIFF FORFEITURE FUND	FORFEIT FORFEIT	500.00			14,930.42
2008 057 LAW ENFORCE BLK GRANT	MAIN	14,430.42			14,930.42
2008 058 LAW ENFORCEMENT BLK GRANT 20MAIN					
2008 059 SHERIFF COMMISSARY FUND	MAIN	44,365.81			44,365.81
2008 061 1971 BOND I&S FUND(UNL TX I&UNL TX I&S TD-UNL I&S					
2008 062 1977 & 1977A I&S FUND(R&B I&R&B I&S TD R&B I&S					
2008 063 1993 JAIL I&S FUND	JAIL I&S TD-JAIL I&S	5,026.82			5,026.82
2008 064 2004 ROW I&S	ROW I&S	212,440.89			212,440.89
2008 065 2006 I&S LOOP PROJECT	I&S06 LOOP	249,966.87			249,966.87
2008 067 2007 LOOP BOND	07LB I&S	1,795,792.18			1,795,792.18
2008 071 HIGHWAY ROW FUND	UNL TX ROW TD-UNLROW	18,380.63			855,346.79
2008 073 TITUS COUNTY BELL TOWER FUNDMAIN		836,966.16			2,431.78-
2008 074 WAR MEMORIAL	MAIN	2,431.78-			
2008 075 2004 RIGHT OF WAY	2004 ROW TD-04 ROW	220,053.60			3,470,053.60
2008 076 LOOP CONSTRUCTION FUND	LOOP LOOP LOOP	3,250,000.00			480,102.71
2008 083 COMMISSARY STORE	COMM STORE	28,700,000.00			606,435.10
		3,032.18			29,786,537.81

44,365.81 <2,1750.84> = 41,614.97

<935,367> = 271,352.45

COMBINED STATEMENT OF CASH POSITION FOR JANUARY

FUND NAME	CHECKING ACCOUNT	CHECKING AMOUNT	TDOA ACCOUNT	TDOA AMOUNT	FUND TOTAL
2008 084 ELECTION FUND	MAIN	89,763.66-			89,763.66-
2008 085 MAINTENANCE BLDG FUND	MAIN	5,472.50-	<537,48>	<6,009,98>	5,472.50-
2008 086 INSURANCE FUND	MAIN INS	211,569.43-			292,113.56
2008 090 DISTRICT CLERK AGENCY FUND					
2008 091 COUNTY CLERK CASH BOND ACCT BAIL BOND		77,926.75			77,926.75
2008 096 GENERAL FIXED ASSETS					
2008 097 GENERAL L/T DEBT ACCOUNT GRO					
2008 098 PAYROLL CLEARING FUND	PAYROLL	608.75			608.75

TOTAL 44,592,745.65 <89,200.52> = 44,503,485.13 44,592,745.65



CHECK ACCOUNT

CHECK

ACCOUNT BALANCE - MAIN	3,508,095.58
ACCOUNT BALANCE - TD-MAIN	3,000,000.00
ACCOUNT BALANCE - TAX ACCT	190,583.25
ACCOUNT BALANCE - TX CAP ESC	20,280.84
ACCOUNT BALANCE - TD-TXCAPES	405,000.00
ACCOUNT BALANCE - SHERIFF	101,174.79
ACCOUNT BALANCE - DA SEIZED	258,614.38
ACCOUNT BALANCE - FORFEITURE	133,650.76
ACCOUNT BALANCE - FORFEIT	14,930.42
ACCOUNT BALANCE - JAIL I&S	5,026.82
ACCOUNT BALANCE - ROW I&S	212,440.89
ACCOUNT BALANCE - I&S06 LOOP	249,966.87
ACCOUNT BALANCE - 07LB I&S	1,795,792.18
ACCOUNT BALANCE - UNL TX ROW	18,380.63
ACCOUNT BALANCE - TD-UNLROW	836,966.16
ACCOUNT BALANCE - 2004 ROW	220,053.60
ACCOUNT BALANCE - TD-04 ROW	3,250,000.00
ACCOUNT BALANCE - LOOP	29,786,537.81
ACCOUNT BALANCE - COMM STORE	3,032.18
ACCOUNT BALANCE - INS	503,682.99
ACCOUNT BALANCE - BAIL BOND	77,926.75
ACCOUNT BALANCE - PAYROLL	608.75

TOTAL 44,592,745.65

TDOA ACCOUNT

TDOA

TOTAL

44,592,745.65

# TITUS COUNTY

Titus County Courthouse



*Sam W. Russell*  
County Judge

January 31, 2008

Jeff Austin, III  
NET RMA  
305 South Broadway Avenue Suite 100  
Tyler TX 75702

Dear Mr. Austin:

This letter is to inform you that on Monday, January 28, 2008 the Commissioners' Court of Titus County, Texas approved the reappointment of Hudson Old to represent Titus County on the NET RMA Board of Directors beginning February 1, 2008.

Please let me know if any further information is needed.

Sincerely,

A handwritten signature in black ink, appearing to read "Sam W. Russell", written in a cursive style.

Sam W. Russell  
Titus County Judge

To: History Programs Division  
Texas Historical Commission  
P.O. Box 12276  
Austin, TX 78711-2276  
512-463-6063  
egina.reyes@thc.state.tx.us

**Additional Titus County Historical Commission Members for 2007-2009<sup>8</sup>.**  
**These are new members only. All previous appointments are still effective.**

Claude Alexander, Jr., Chair  
504 Magnolia Drive  
Mt. Pleasant, TX 75455  
903-572-2797  
e-mail: [claudio-a@att.net](mailto:claudio-a@att.net)

Adams, Pat  
1604 N. Jefferson  
Mt. Pleasant, TX 75455  
903-572-8567

Hobbs, Rosemary  
P. O. Box 1303  
Mt. Pleasant, TX 75456-1303  
903-572-1018

Palmer, Sharon  
P. O. Box 1177  
Mt. Pleasant, TX 75456-1177  
903-572-8097

Antonelli, Patricia  
1205 E. First Street  
Mt. Pleasant, TX 75455  
903-577-8281

Hollingsworth, Betty  
1160 CR 4550  
Mt. Pleasant, TX 75455  
903-572-2388

Russell, Janet  
2991 CR 1550  
Mt. Pleasant, TX 75455  
903-466-3232

Evenwel, Sue  
298 Greenhill Park Ave  
Mt. Pleasant, TX 75455  
903-572-0653

Kennedy, Diana  
310 CR 2340  
Mt. Pleasant, TX 75455  
903-572-0224

Sivess, Dorothy  
406 W. First Street  
Mt. Pleasant, TX 75455  
903-572-4709

Hammonds, Judy  
330 CR 1787  
Mt. Pleasant, TX 75455  
903-572-1549

Lindsey, Billy Joe  
3828 CR 4260  
Mt. Pleasant, TX 75455  
903-572-6264



County Judge, Presiding Officer  
Titus County Commissioner's Court

1/28/08  
Date

\* \* \* Communication Result Report ( Jan. 30. 2008 10:32AM ) \* \* \*

1)  
2)

Date/Time: Jan. 30. 2008 10:32AM

File No.	Mode	Destination	Pg(s)	Result	Page Not Sent
2866	Memory TX	915124753122	P. 2	OK	

Reason for error

- E. 1) Hang up or line fail
- E. 2) Busy
- E. 3) No answer
- E. 4) No facsimile connection
- E. 5) Exceeded max. E-mail size



**TITUS COUNTY**  
Titus County Courthouse

**FACSIMILE COVER SHEET**

**TO:** History Programs Division  
**COMPANY:** Texas Historical Commission  
**FAX:** 512-475-3122

**FROM:** Sam W. Russell  
 Titus County Judge  
 100 W. 1<sup>st</sup>, Suite 200  
 Mt Pleasant TX 75455

**PHONE:** (903) 577-6791  
**FAX:** (903) 577-6793

**DATE:** 1-30-08

**PAGES:** 2 (including cover sheet)

**COMMENTS:**

The date on the Additional Titus County  
Historical Commission members approved  
should be for 2007-2008 instead of 2009.

**THANK YOU & HAVE A GREAT DAY!**

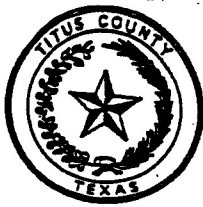

**TITUS COUNTY**  
Titus County Courthouse

**FACSIMILE COVER SHEET**

**TO:** History Programs Division  
**COMPANY:** Texas Historical Commission  
**FAX:** 512-475-3122

**FROM:** Sam W. Russell  
Titus County Judge  
100 W. 1<sup>st</sup>, Suite 200  
Mt Pleasant TX 75455

**PHONE:** (903) 577-6791  
**FAX:** (903) 577-6793

**DATE:** 1-30-08

**PAGES:** 2 (including cover sheet)

**COMMENTS:**

The date on the Additional Titus County  
Historical Commission members approved  
should be for 2007-2008 instead of 2009.

---

---

**THANK YOU & HAVE A GREAT DAY!**

\* \* \* Communication Result Report ( Jan. 29. 2008 3:57PM ) \* \* \*

}}  
2}}

Date/Time: Jan. 29. 2008 3:57PM

File No.	Mode	Destination	Pg(s)	Result	Page Not Sent
2857	Memory TX	915124753122	P. 1	OK	

Reason for error

- E. 1) Hang up or line fail
- E. 2) Busy
- E. 3) No answer
- E. 4) No facsimile connection
- E. 5) Exceeded max. E-mail size

To: History Programs Division  
 Texas Historical Commission  
 P.O. Box 12276  
 Austin, TX 78711-2276  
 512-463-6063  
 egma.reyes@thc.state.tx.us

Additional Titus County Historical Commission Members for 2007-2009.  
 These are new members only. All previous appointments are still effective.

Claude Alexander, Jr., Chair  
 504 Magnolia Drive  
 Mt. Pleasant, TX 75455  
 903-572-2797  
 e-mail: [claude-a@att.net](mailto:claude-a@att.net)

Adams, Pat  
 1604 N. Jefferson  
 Mt. Pleasant, TX 75455  
 903-572-8567

Hobbs, Rosemary  
 P. O. Box 1303  
 Mt. Pleasant, TX 75456-1303  
 903-572-1018

Palmer, Sharon  
 P. O. Box 1177  
 Mt. Pleasant, TX 75456-1177  
 903-572-8097

Antonelli, Patricia  
 1205 E. First Street  
 Mt. Pleasant, TX 75455  
 903-577-8281

Hollingsworth, Betty  
 1160 CR 4550  
 Mt. Pleasant, TX 75455  
 903-572-2388

Russell, Janet  
 2991 CR 1550  
 Mt. Pleasant, TX 75455  
 903-466-3232

Evenwel, Sue  
 298 Greenhill Park Ave  
 Mt. Pleasant, TX 75455  
 903-572-0653

Kennedy, Diana  
 310 CR 2340  
 Mt. Pleasant, TX 75455  
 903-572-0224

Sivasa, Dorothy  
 406 W. First Street  
 Mt. Pleasant, TX 75455  
 903-572-4709

Hammonds, Judy  
 330 CR 1787  
 Mt. Pleasant, TX 75455  
 903-572-1549

Lindsay, Billy Joe  
 3828 CR 4260  
 Mt. Pleasant, TX 75455  
 903-572-6264

  
 County Judge, Presiding Officer  
 Titus County Commissioner's Court

1/28/08  
 Date

To: History Programs Division  
Texas Historical Commission  
P.O. Box 12276  
Austin, TX 78711-2276  
512-463-6063  
egina.reyes@thc.state.tx.us

*Interim  
appts*

**Additional Titus County Historical Commission Appointments for 2007-2008.  
These are new members only. All previous appointments are still effective.**

Claude Alexander, Jr., Chair  
504 Magnolia Drive  
Mt. Pleasant, TX 75455  
903-572-2797  
e-mail: [claudio-a@att.net](mailto:claudio-a@att.net)

Pat Adams  
1604 N. Jefferson  
Mt. Pleasant, TX 75455  
903-572-8567

Rosemary Hobbs  
P. O. Box 1303  
Mt. Pleasant, TX 75456-1303  
903-572-1018

Billy Joe Lindsey  
3828 CR 4260  
Mt. Pleasant, TX 75455  
903-572-6264

Patricia Antonelli:  
1205 E. First Street:  
Mt. Pleasant, TX 75455  
903-577-8281

Betty Hollingsworth  
1160 CR 4550  
Mt. Pleasant, TX 75455  
903-572-2388

Sharon Palmer  
P. O. Box 1177  
Mt. Pleasant, TX 75456-1177  
903-572-8097

Judy Hammonds  
330 CR 1787  
Mt. Pleasant, TX 75455  
903-572-1549

Diana Kennedy  
310 CR 2340  
Mt. Pleasant, TX 75455  
903-572-0224

Janet Russell  
2991 CR 1550  
Mt. Pleasant, TX 75455  
903-466-3232

Dorothy Sivess  
406 W. First Street  
Mt. Pleasant, TX 75455  
903-572-4709

---

County Judge, Presiding Officer  
Titus County Commissioner's Court

Date \_\_\_\_\_

# **Titus County Roofing Projects**

**Progress Report  
January 28, 2006**



# TITUS COUNTY COURTHOUSE

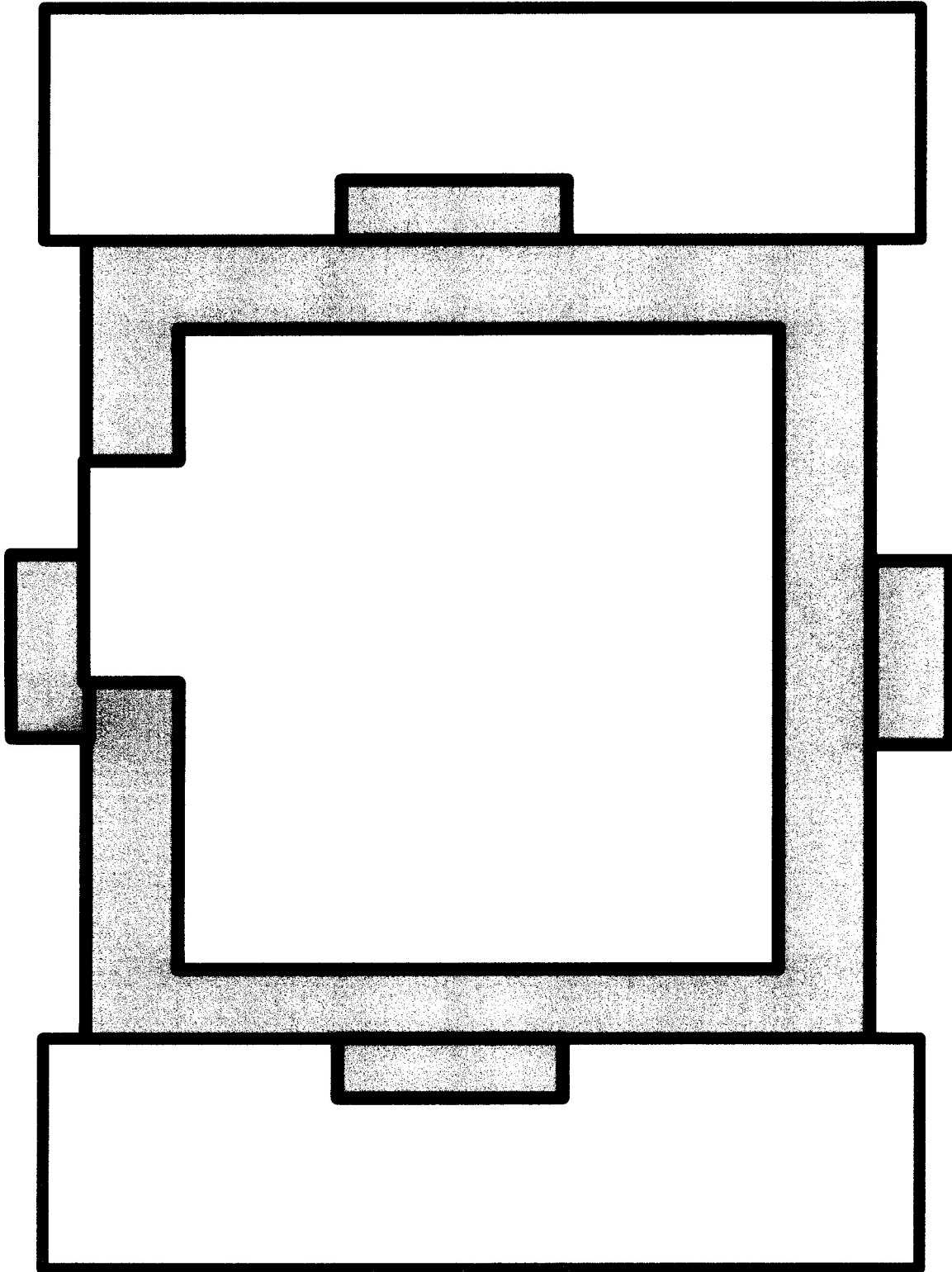

January 28, 2008 Progress

1. This entire facility is roofed.
2. Metal, work, and counterflashings are yet to be finished.

# Titus County Annex & Witt Building

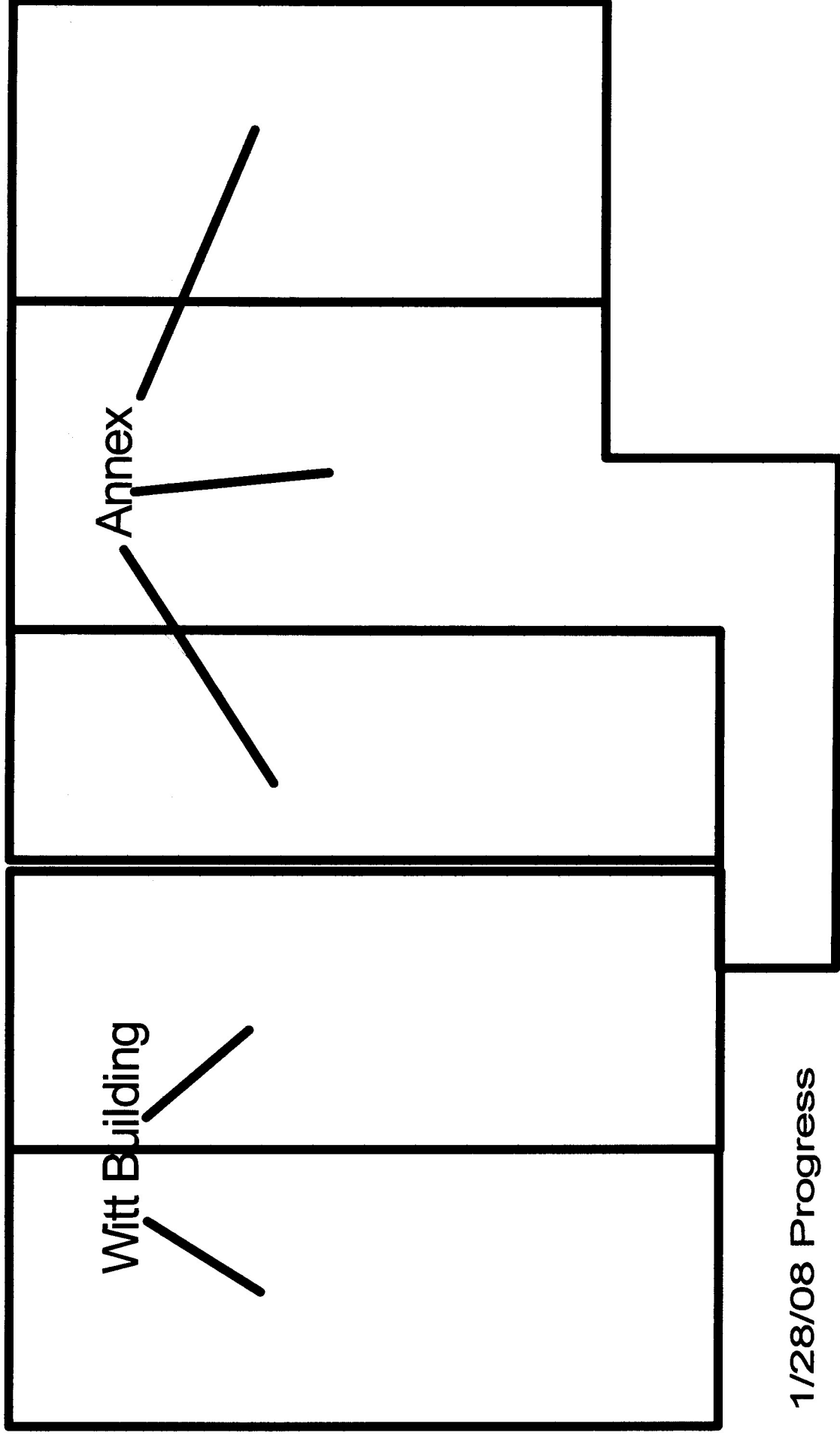

1/28/08 Progress

1. All Blue hatched areas are roofed, with some metal perimeter yet to be finished.
2. Red Hashed area is roofed minus metal perimeter and gravel surface
3. Clear area is still old roof.

# Titus County Election Center

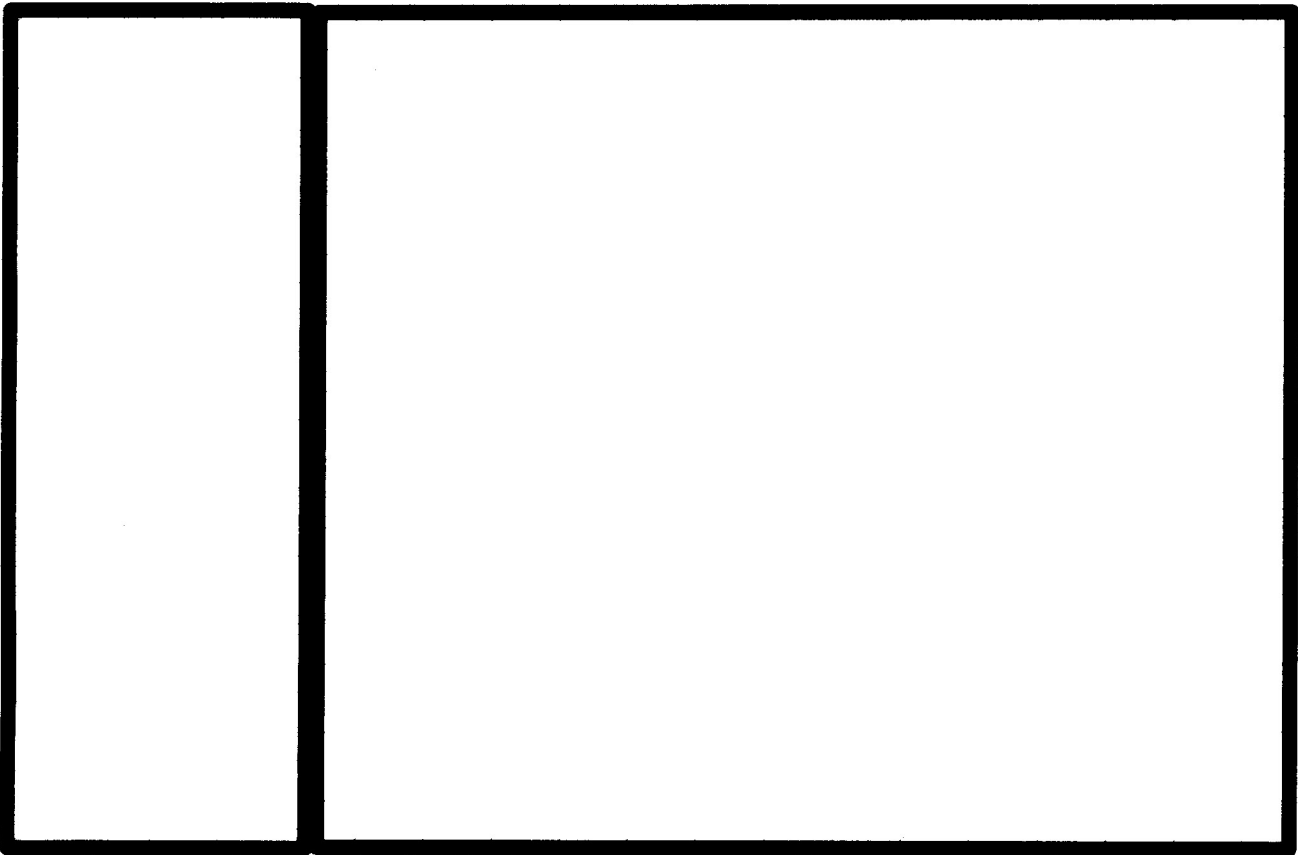

## 1/28/08 Progress

1. Entire metal perimeter is unfinished, metal between old metal and new metal is being fabricated.
2. Blue Hatched area is finished.
3. Red Hatched area had a cap sheet on order.

# Titus County Jail & Sheriff's Office

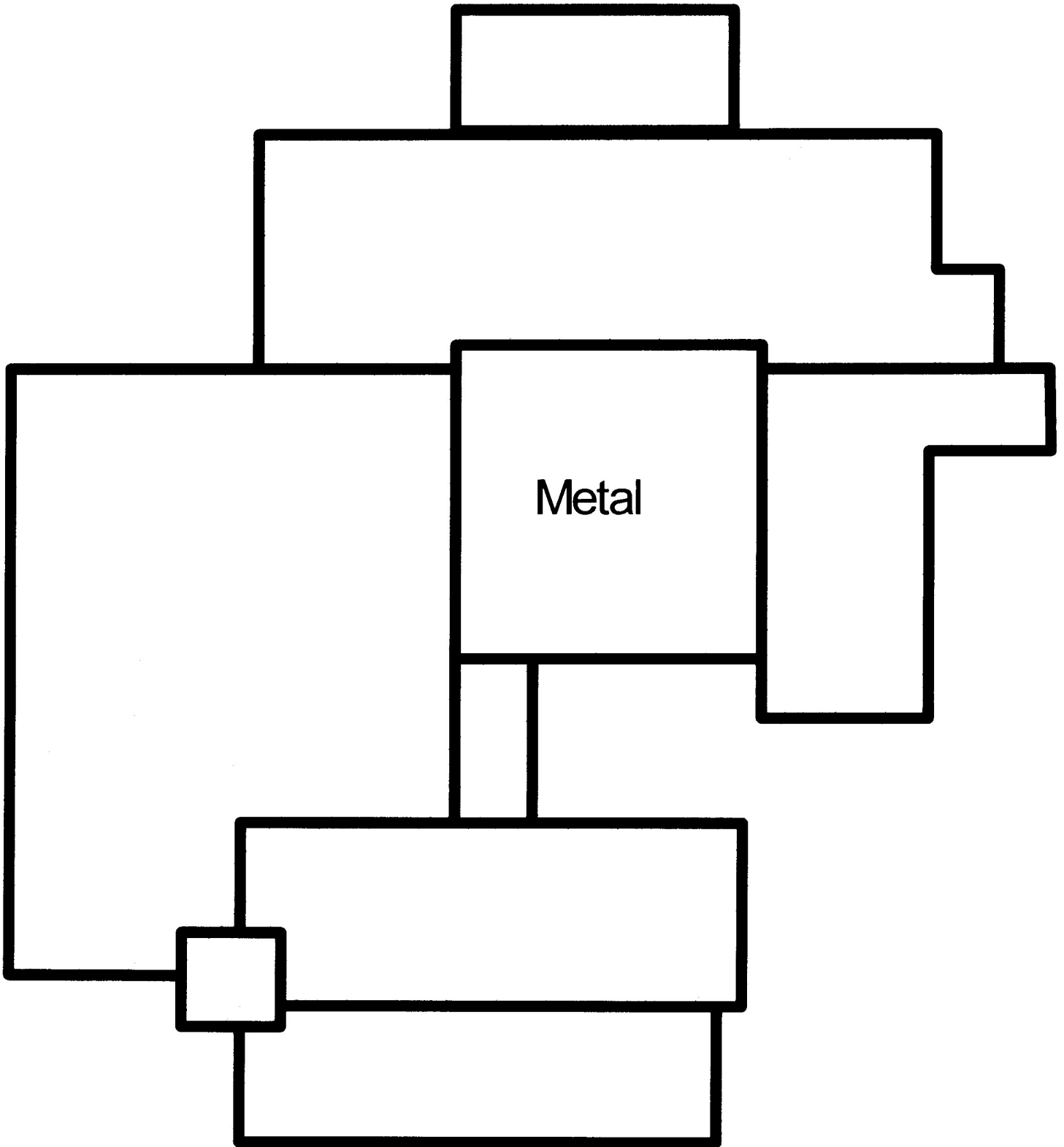

## 1/28/08 Progress

1. Hatched area has had all of the gravel and any loose material vacuummed and ready for restoration or replacement.