

**COMMISSIONERS' COURT  
REGULAR MEETING  
April 12, 1999**

**BE IT REMEMBERED THAT THE TITUS COUNTY COMMISSIONERS' COURT met in *Regular Session* on Monday, April 12, 1999, in the Titus County Courtroom with the following members present:**

DANNY P. CROOKS.....COUNTY JUDGE  
MIKE PRICE.....COMMISSIONER PRECINCT 1  
MIKE FIELDS.....COMMISSIONER PRECINCT 2  
BILLY J. THOMPSON.....COMMISSIONER PRECINCT 3  
THOMAS E. HOCKADAY.....COMMISSIONER PRECINCT 4  
JEAN CROVER.....DEPUTY COUNTY CLERK

**ABSENT: NONE**

**PUBLIC AND COUNTY OFFICIALS ATTENDING MEETING:**

CARL JOHNSON, AUDITOR  
JUNE ROACH, COUNTY TAX ASSESSOR - COLLECTOR  
SHERRY MARS, COUNTY CLERK  
RICKY POOLE, SHERIFF  
KEN SCHINDLEY, CHIEF DEPUTY SHERIFF

TOM MERRIWETHER                      RALPH RANDALL  
ANN RUNDLE

Invocation was given by Reverend Glen Griffith.

**IN THE MATTER OF  
APPROVING BIDS FOR (1) TON TRUCK AND  
A 2 ½ TON TRUCK**

Motion was made by Commissioner Billy J. Thompson and seconded by Commissioner Mike Price to table this matter until the next meeting. Motion carried unanimously.

IN THE MATTER OF  
AWARDING BID FOR TRACTORS  
FOR PRECINCT 1

Pittsburg Tractor Inc. and Conroy Tractor, Inc. submitted bids for the 2 tractors for Precinct 1.

Motion was made by Commissioner Mike Price and seconded by Commissioner Mike Fields to award the bid for one 2 wheel drive tractor at \$33,994.00 and one 4 wheel drive tractor at \$38,994.00 to Conroy Tractor, Inc. Motion carried unanimously. *SEE ATTACHMENT "A"*

IN THE MATTER OF  
CONSIDERING RESOLUTION FOR HOUSING  
FOR PAROLE VIOLATORS

Chief Deputy Sheriff Ken Schindley explained that all inmates picked up on now on a Governor's Blue Warrant must be provided with housing and food without compensation to the County. This resolution would allow the County to recover \$35.00 a day from the State or allow these parole violators to be immediately placed in a state facility.

Motion was made by Commissioner Mike Price and seconded by Commissioner Thomas E. Hockaday to approve the Resolution for Housing for parole violators. Motion carried unanimously. *SEE ATTACHMENT "B"*.

IN THE MATTER OF  
DEPUTATION OF LARRY MAC MACOMBER  
AS DEPUTY SHERIFF

Motion was made by Commissioner Mike Price and seconded by Commissioner Billy J. Thompson to approve the deputation of Larry Mac Macomber as deputy sheriff. Motion carried unanimously.

IN THE MATTER OF  
CONSIDERING AND POSSIBLY APPROVE EXTENDING  
INMATES PHONE CONTRACT

The commission on the inmates phone contract has been allowing the Sheriff's Office to keep their computer system upgraded. The County Judge's office will be receiving a computer and a lap top computer. This will benefit both of our offices stated Mr. Schindley.

Motion was made by Commissioner Mike Price and seconded by Commissioner Thomas E. Hockaday to approve extending the inmate phone company contract with Evercom. Motion carried unanimously. *SEE ATTACHMENT "C"*

IN THE MATTER OF  
APPROVING PHASE 2, PLEASANT HILLS ADDITION  
IN PRECINCT 4

Motion was made by Commissioner Thomas E. Hockaday and seconded by Commissioner Billy J. Thompson to approve Phase 2, Pleasant Hills Addition in Precinct 4. Motion carried unanimously.

IN THE MATTER OF  
APPROVING SOUTHWESTERN BELL TELEPHONE COMPANY  
BURYING CABLE ALONG AND ACROSS NE-32 IN PRECINCT 3

Motion was made by Commissioner Billy J. Thompson and seconded by Commissioner Mike Fields to approve Southwestern Bell Telephone Company burying cable along and across NE-32 in Precinct 3 with the exception that all roads and driveways be bored under. Motion carried unanimously. *SEE ATTACHMENT "D"*

IN THE MATTER OF  
APPROVING SOUTHWESTERN BELL TELEPHONE COMPANY  
BURYING CABLE ALONG AND ACROSS SE-15 IN PRECINCT 4

Motion was made by Commissioner Thomas E. Hockaday and seconded by Commissioner Mike Price to approve Southwestern Bell Telephone Company burying cable along and across SE-15 in Precinct 4 with the

exception that all roads and driveways be bored under. Motion carried unanimously. SEE ATTACHMENT "E"

IN THE MATTER OF  
DISCUSSING AND CLARIFYING ITEMS OF EXPENSE ELIGIBLE  
FOR PREPAYMENT FOR COUNTY EMPLOYEES REQUIRED TO  
TRAVEL FOR COUNTY PURPOSES

Motion was made by Commissioner Mike Price and seconded by Commissioner Thomas E. Hockaday to approve payment of expenses as follows:

- A. Seminar Fees - To be paid up front to Seminar by check
  - B. Lodging - To be paid up front to hotel by check or charged  
On personal credit card then reimbursed
  - C. Mileage - To be paid at the IRS standard rate of 31 cents per  
mile (mileage to be counted from Titus County  
Courthouse until return to courthouse)
  - D. Meals - To be paid at \$30.00 per day.
- Motion carried unanimously.

IN THE MATTER OF  
APPROVING MINUTES OF MARCH, 1999

Motion was made by Commissioner Thomas E. Hockaday and seconded by Commissioner Mike Price to approve the minutes for March, 1999. Motion carried unanimously.

IN THE MATTER OF  
APPROVING BUDGET AMENDMENTS

None were presented.

IN THE MATTER OF  
APPROVING COUNTY OFFICIAL REPORTS

Motion was made by Commissioner Thomas E. Hockaday and seconded by Commissioner Billy J. Thompson to approve reports from County Auditor, County Treasurer, Tax Assessor-Collector, County Clerk, Justice of the Peace, Precinct 1, Justice of the Peace, Precinct 2, Cookville Volunteer Fire



Department, City of Talco Fire Department, Fire Star Volunteer Fire Department and Tri-Lake Volunteer Fire Department. Motion carried unanimously.

IN THE MATTER OF  
APPROVING SIGNING PAY ORDERS AND  
PAYING BILLS

Motion was made by Commissioner Thomas E. Hockaday and seconded by Commissioner Billy J. Thompson to sign pay orders and pay bills. Motion carried unanimously.

IN THE MATTER OF  
APPOINTING JIM TATMAN AS  
ON-SITE SEWERAGE INSPECTOR

Motion was made by Commissioner Mike Price and seconded by Commissioner Billy J. Thompson to approve Jim Tatman as on-site sewerage inspector. Jim Tatman was duly certified and has been serving as on-site sewerage inspector since January 19, 1999. Motion carried unanimously.

IN THE MATTER OF  
APPROVING SOUTHWESTERN BELL TELEPHONE COMPANY  
BURYING CABLE ALONG AND UNDER NE-36 IN PRECINCT 3

Motion was made by Commissioner Billy J. Thompson and seconded by Commissioner Mike Price to approve Southwestern Bell Telephone Company burying cable along and under NE-36 in Precinct 3. Motion carried unanimously. *SEE ATTACHMENT "F"*

IN THE MATTER OF  
EXECUTIVE SESSION

The Court went into Executive Session at 10:07 a.m. and reconvened at 10:30 a.m. No action was taken.

VOL 26 PAGE 94

IN THE MATTER OF  
ADJOURNMENT

Motion was made by Commissioner Billy J. Thompson and seconded by  
Commissioner Mike Fields to adjourn. Motion carried unanimously.

---

The above and foregoing minutes for the month of MARCH, were read and approved this 12th day of APRIL, 1999.

Dann P. Crooks  
DANN P. CROOKS, COUNTY JUDGE

Mike Price  
MIKE PRICE, COMMISSIONER PRECINCT #1

Mike Fields  
MIKE FIELDS, COMMISSIONER PRECINCT #2

Billy J. Thompson  
BILLY J. THOMPSON, COMMISSIONER PRECINCT #3

Thomas E. Hockaday  
THOMAS E. HOCKADAY, COMMISSIONER PRECINCT #4

Sherry Mars  
SHERRY MARS, COUNTY CLERK

COMMISSIONERS' COURT MINUTES FOR MARCH, 1999 A.D.  
RECORDED ON THE 13TH DAY OF APRIL, 1999, A.D.

SHERRY MARS, COUNTY CLERK  
TITUS COUNTY, TEXAS

By Juan Cresce DEPUTY COUNTY CLERK

\*\*\*\*\*



**CONROY TRACTOR, INC.**

P.O. BOX 312 2809 WEST FERGUSON  
MT. PLEASANT, TEXAS 75456-0312  
903-572-2629



TO: William White  
From: Conroy Ford Tractor  
Reference: Tractor Bid

Date: March 15, 1999

Mr. White,

We appreciate the opportunity to bid on the tractors listed below. Both tractors will meet or exceed all your specifications.

Specifications are enclosed. Delivery date 45-60 days.

1-2WD, TS110 New Holland Tractor \$33,994.00  
1-4WD, TS110 New Holland Tractor \$38,994.00

Sincerely,

  
Johnny O. Conroy

NEW HOLLAND  
TS110 (90 Hp PTO)

## POWER PERFORMANCE

Gross Engin in Hp(Kw)	108(80.5)
Net Engine in Hp(Kw)	106.2(79.2)
PTO in Hp(Kw)	90(67.5)
Maximum PTO Torque in LbFt(Nm)	328(448.1)
Maximum Torque Speed in Rpm	1,400
PTO Torque Raise in %	28
Engine Torque Raise in %	INA
PTO Speed at Rated Speed in Rpm	591 & 1,010
Fuel Consumption in Lb/HpHr(Kg/KwHr)	0.349

## ENGINE

Make and Model	NH, Genesis TM
Block Design	parent bore
Number of Cylinders	4
Displacement in CuIn(L)	304(5.0)
Bore and Stroke in In(Mm)	4.4x5.0(11.8x127)
Rated Engine Speed in Rpm	2,070
Low Idle Speed in Rpm	725-775
High Idle Speed in Rpm	2,220
Aspiration	turbocharged
Air Cleaner Type	dual, dry element
Compression Ratio	17.5 : 1
Firing Order	1-3-4-2
Lubrication System	
Oil Pump Flow Rate in Gpm(Lpm)	17.9(68)
Oil Pump Pressure in Psi(Bar)	INA
Fuel and Induction System	
Turbocharger Type	not applicable
Injection Pump Make/Model/Type	Lucas / DP203 / rotary
Pump Timing in Degrees	3 BTDC
Pump Rotation	INA
Fuel Injectors Make/Model/Type	Lucas/multi-hole/direct
Injector Opening Pressure in Psi(Bar)	4,205(290)
Cooling System	
System Type	pressurized full flow bypass
Water Pump Type	impeller
Drive	poly v belt
Opening Temperature in F(C)	199-205(93-96)
Fan Drive Type	viscous
Fan Diameter in In(Mm)	18.9(480)
Number of Blades	5

NEW HOLLAND  
TS110 (90 Hp PTO)**ELECTRICAL SYSTEM**

System Rating in Volts	12
Alternator Rating in Ampe	55 or 100
Starter Rating in Hp(Kw)	4.2(3.15)
Cold Cranking Amperage in Ampe	800 x 2
Polarity	negative ground
Number of Batteries	1 or 2
Battery Capacity in Amp Hours	107 x 2
Cold Start Aid	thermostart

**TRANSMISSION**

Basic Configuration	EconoShift
Type	8 x 2
Number of ForwardxReverse Speeds	constant mesh
Gear Type	4 forward, 1 reverse
Gear Shifting	non-synchronized
Range Shifting	2 non-synchronized
Shuttling	range gears
Clutch Type	no forward / reverse
Clutch Diameter in In(Mm)	directional control
Number of Clutch Plates	dry, single plate
Clutch Actuation	13(330)
ForwardxReverse Speeds w/ Creeper	1
Forward at Rated Rpm in Mph(Kph)	mechanical
1L DIRECT	12 x 3
1H DIRECT	1.6(2.6)
2L DIRECT	6.0(9.7)
2H DIRECT	2.1(3.4)
3L DIRECT	7.5(12.1)
3H DIRECT	3.7(6.0)
4L DIRECT	13.2(21.3)
4H DIRECT	5.0(8.1)
Reverse at Rated Rpm in Mph(Kph)	18(29)
1L DIRECT	2.5(4.0)
1H DIRECT	8.5(13.6)
Optional Configuration 1	
Type	Dual EconoShift
Number of ForwardxReverse Speeds	16 x 4
Gear Type	constant mesh
Gear Shifting	4 forward, 1 reverse
Range Shifting	non-synchronized
	2 non-synchronized

NEW HOLLAND  
TS110 (90 Hp PTO)**Optional Configuration 1 (Cont.)**

<b>Shuttling</b>	w/ Underdrive switch no forward / reverse directional control
<b>Clutch Type</b>	dry, single plate
<b>Clutch Diameter in In(Mm)</b>	13(330)
<b>Number of Clutch Plates</b>	1
<b>Clutch Actuation</b>	mechanical
<b>ForwardxReverse Speeds w/ Creeper</b>	24 x 6
<b>Forward at Rated Rpm in Mph(Kph)</b>	
1L UNDER DRIVE	1.3(2.1)
1L DIRECT	1.7(2.7)
1H UNDER DRIVE	4.7(7.6)
1H DIRECT	6.0(9.7)
2L UNDER DRIVE	1.6(2.6)
2L DIRECT	2.1(3.4)
2H UNDER DRIVE	5.9(9.4)
2H DIRECT	7.5(12.1)
3L UNDER DRIVE	2.9(4.6)
3L DIRECT	3.7(6.0)
3H UNDER DRIVE	10(16.6)
3H DIRECT	13.2(21.3)
4L UNDER DRIVE	3.9(6.3)
4L DIRECT	5.0(8.1)
4H UNDER DRIVE	14(23)
4H DIRECT	18(29)
<b>Reverse at Rated Rpm in Mph(Kph)</b>	
1L UNDER DRIVE	1.9(3.0)
1L DIRECT	2.4(3.9)
1H UNDER DRIVE	6.7(10.9)
1H DIRECT	8.7(14)
<b>Optional Configuration 2</b>	
<b>Type</b>	SynchroShift
<b>Number of ForwardxReverse Speeds</b>	12 x 12
<b>Gear Type</b>	constant mesh
<b>Gear Shifting</b>	4 synchronized main gears
<b>Range Shifting</b>	3 synchronized range gears
<b>Shuttling</b>	forward / reverse directional control
<b>Clutch Type</b>	dry, single plate
<b>Clutch Diameter in In(Mm)</b>	13(330)
<b>Number of Clutch Plates</b>	1
<b>Clutch Actuation</b>	mechanical

NEW HOLLAND  
TS110 (90 Hp PTO)

## Optional Configuration 2 (Cont.)

ForwardxReverse Speeds w/ Creeper not applicable

Forward at Rated Rpm in Mph(Kph)

1L DIRECT	1.2(1.9)
1M DIRECT	2.7(4.3)
1H DIRECT	5.9(9.5)
2L DIRECT	1.7(2.7)
2M DIRECT	3.9(6.2)
2H DIRECT	8.6(13.8)
3L DIRECT	2.3(3.7)
3M DIRECT	5.3(8.5)
3H DIRECT	11.7(18.7)
4L DIRECT	3.6(5.8)
4M DIRECT	8.2(13.1)
4H DIRECT	18(29)

Reverse at Rated Rpm in Mph(Kph)

1L DIRECT	1.2(2)
1M DIRECT	2.8(4.4)
1H DIRECT	6.1(9.8)
2L DIRECT	1.8(2.9)
2M DIRECT	4(6.4)
2H DIRECT	8.8(14.1)
3L DIRECT	2.4(3.8)
3M DIRECT	5.4(8.6)
3H DIRECT	12(19.2)
4L DIRECT	3.7(5.9)
4M DIRECT	8.4(13.5)
4H DIRECT	18.5(29.7)

## Optional Configuration 3

Type	Dual SynchroShift
Number of ForwardxReverse Speeds	24 x 24
Gear Type	constant mesh
Gear Shifting	4 synchronized main w/ Hi / Lo
Range Shifting	3 synchronized range gears
Shuttling	clutchless directional control
Clutch Type	wet disc, multi-plate
Clutch Diameter in in(Mm)	6.1(155)
Number of Clutch Plates	5
Clutch Actuation	electro-hydraulic
ForwardxReverse Speeds w/ Creeper	not applicable
Forward at Rated Rpm in Mph(Kph)	
1L POWER	1.0(1.6)



## Optional Configuration 3 (Cont.)

1L DIRECT	1.2(1.9)
1M POWER	2.3(3.7)
1M DIRECT	2.8(4.5)
1H POWER	5.1(8.2)
1H DIRECT	6.2(9.9)
2L POWER	1.5(2.4)
2L DIRECT	1.8(2.9)
2M POWER	3.4(5.4)
2M DIRECT	4.1(6.6)
2H POWER	7.4(11.8)
2H DIRECT	9.1(14.6)
3L POWER	2.0(3.2)
3L DIRECT	2.5(4.0)
3M POWER	4.6(7.4)
3M DIRECT	5.6(9.0)
3H POWER	10.0(16.0)
3H DIRECT	12.3(19.7)
4L POWER	3.1(5.0)
4L DIRECT	3.8(6.1)
4M POWER	7.0(11.2)
4M DIRECT	8.6(13.8)
4H POWER	15.5(24.8)
4H DIRECT	18.9(30.2)

## Reverse at Rated Rpm in Mph(Kph)

1L POWER	1.0(1.6)
1L DIRECT	1.2(1.9)
1M POWER	2.3(3.7)
1M DIRECT	2.8(4.5)
1H POWER	5.1(8.2)
1H DIRECT	6.2(9.9)
2L POWER	1.5(2.4)
2L DIRECT	1.8(2.9)
2M POWER	3.4(5.4)
2M DIRECT	4.1(6.6)
2H POWER	7.4(11.8)
2H DIRECT	9.1(14.6)
3L POWER	2.0(3.2)
3L DIRECT	2.5(4.0)
3M POWER	4.6(7.4)
3M DIRECT	5.6(9.0)
3H POWER	10.0(16.0)
3H DIRECT	12.3(19.7)
4L POWER	3.1(5.0)
4L DIRECT	3.8(6.1)

NEW HOLLAND  
TS110 (90 Hp PTO)

## Optional Configuration 3 (Cont.)

4M POWER	7.0(11.2)
4M DIRECT	8.6(13.8)
4H POWER	15.5(24.8)
4H DIRECT	18.9(30.2)

## Optional Configuration 4

Type	ElectroShift
Number of ForwardxReverse Speeds	16 x 16
Gear Type	constant mesh
Gear Shifting	8 synchronized main gears
Range Shifting	2 synchronized range gears
Shuttling	clutchless directional control
Clutch Type	wet disc, multi-plate
Clutch Diameter in In(Mm)	6.3(159)
Number of Clutch Plates	8
Clutch Actuation	electro-hydraulic
ForwardxReverse Speeds w/ Creeper	24 x 24
Forward at Rated Rpm in Mph(Kph)	
1L DIRECT	1.4(2.2)
1H DIRECT	4.2(6.8)
2L DIRECT	1.7(2.7)
2H DIRECT	5.2(8.3)
3L DIRECT	2.0(3.3)
3H DIRECT	6.3(10.2)
4L DIRECT	2.5(4)
4H DIRECT	7.7(12.4)
5L DIRECT	3.2(5.2)
5H DIRECT	10(16)
6L DIRECT	3.9(6.3)
6H DIRECT	12.2(20)
7L DIRECT	4.8(7.7)
7H DIRECT	15(24)
8L DIRECT	5.9(9.5)
8H DIRECT	18.2(29)
Reverse at Rated Rpm in Mph(Kph)	
1L DIRECT	1.4(2.2)
1H DIRECT	4.2(6.8)
2L DIRECT	1.7(2.7)
2H DIRECT	5.2(8.3)
3L DIRECT	2.0(3.3)
3H DIRECT	6.3(10.2)
4L DIRECT	2.5(4)

NEW HOLLAND  
TS110 (90 Hp PTO)

## Optional Configuration 4 (Cont.)

4H DIRECT	7.7(12.4)
5L DIRECT	3.2(5.2)
5H DIRECT	10(16)
6L DIRECT	3.9(6.3)
6H DIRECT	12.2(20)
7L DIRECT	4.8(7.7)
7H DIRECT	15(24)
8L DIRECT	5.9(9.5)
8H DIRECT	18.2(29)

## REAR AXLE ASSEMBLY

Final Drive Type	double reduction, inboard planetary
Number Planetary Gear	3
Output Axle Type	flange
Axle Length in In(Mm)	66(1,676.4)
Differential	
Differential Lock	jaw clutch
Method of Engagement	mech. or electro-hyd.

## BRAKE SYSTEM

Brake Type	wet, multi-disc either mechanical or self adjusted
Operation	mech. or electro-hyd.
Number of Disc per Side	3
Disc Diameter in In(Mm)	8.8(223.5)
Parking Brake Type	wet, multi-disc clamp to main brakes or ind.
Operation	mechanical lever
Number of Disc per Side	3
Disc Diameter in In(Mm)	8.8(223.5)

## POWER TAKE OFF

Type	Independent
Engagement and Control	electro-hydraulic
Rotation	clockwise
Engine Rpm at 540 / 1000 PTO Rpm	1,900 / 2,050
Output Shaft Diameter in In(Mm)	
540 Rpm	6 splines, 1.38(35)
1000 Rpm	21 splines, 1.38(35)
PTO Clutch Type	wet disc, multi-plate
Clutch Diameter in In(Mm)	5.85(148.6)
Clutch Material	sintered bronze

## POWER TAKE OFF (Cont.)

## HYDRAULIC SYSTEM

Type of System	open center or closed center load sensing
System Pressure in Psi(Bar)	2600or2750(179or190)
Main Open Center Pump Type	fixed displacement, tandem, external gear
Pump Flow at Rated Engine Rpm in Gpm(Lpm)	17.4(65.9)
Pump Press. at Rated Engine Rpm in Gpm(Lpm)	2,600+/-50(179+/-3)
Charge Pump Type	fixed displacement, external gear
Pump Flow at Rated Engine Rpm in Gpm(Lpm)	24.0(91)
Pump Press. at Rated Engine Rpm in Gpm(Lpm)	35-2,600(2.35-179)
Main CLosed Center Pump Type Type	variable displacement, axial piston
Pump Flow at Rated Engine Rpm in Gpm(Lpm)	20.0(75.8)
Pump Press. at Rated Engine Rpm in Gpm(Lpm)	330-2,750(22.8-189.7)
Remote Control Valves Number of Remotes	2, or 4
Remote Output at Rated Engine Rpm in Gpm(Lpm)	3.5-16(13.2-60.6)
Remote Valve Pressure in Psi(Bar)	2,600+/-50(179+/-3)

## THREE POINT HITCH

Category	II
Draft Sensing Type	mechanical, top link or electronic lower link
Link Ends	flexible
Stabilizers	telescoping
Hitch Lift Cylinder Type	internal, double acting
Cylinder Diameter in In(Mm)	4.1(104.8)
Hitch Relief Pressure in Psi(Bar)	2,650-2,800(183-193)
Assist Ram Type	external, single acting

NEW HOLLAND  
TS110 (90 Hp PTO)**THREE POINT HITCH (Cont.)**

Number of Rams	1 or 2
Cylinder Diameter in In(Mm)	1.77(45)
Lift Capacity	
24 Inch Behind, w/o Assist Ram in Lb(Kg)	4200-4439(1905-1998)
24 Inch Behind, w/ Assist Ram in Lb(Kg)	6210-6564(2817-2954)
24 Inch Behind, w/ 2 Assist Rams in Lb(Kg)	8240-8710(3738-3950)
Standard Drawbar	
Type	swinging
PTO to Hitch Point in In(Mm)	
Hole 1	16(406)
Hole 2	14(356)
Hole 3	9.6(243)
Static Downward Load in Lb(Kg)	
Hole 1	2,000(907)
Hole 2	2,350(1,065)
Hole 3	3,600(1,633)
Optional Drawbar	
Type	roller swinging
PTO to Hitch Point in In(Mm)	
Hole 1	16(406)
Hole 2	14(356)
Hole 3	not applicable
Static Downward Load in Lb(Kg)	
Hole 1	3,000(1,361)
Hole 2	3,600(1,633)
Hole 3	not applicable

**FRONT AXLE / STEERING**

2 Wheel Drive Front Axle	
Type	adjustable, hollow center telescoping beam
Number and Type of Cylinder	1, double acting
Turning Angle in Degrees	55
Axle Oscillation Angle in Degrees	8-12
Axle Width in In(Mm)	60-88(1,524-2,235.2)
Toe Out in In(Mm)	0-0.5(0-13)
4 Wheel Drive Front Axle	
Type	fixed, outboard planetary
Number and Type of Cylinder	2, double acting
Turning Angle in Degrees	55

**FRONT AXLE / STEERING (Cont.)**

Axle Oscillation Angle in Degrees	8-12, 10 caster
Axle Width in In(Mm)	69.8(1,772.9)
Number of Planetary Gears	INA
Front Wheel Toe In in In(Mm)	0-.25(0-6)
Steering System	
Steering Type	Hydrostatic
Pump Type	fixed displacement, external gear

**Pump Flow at Rated Engine Rpm  
in Gpm(Lpm)**

2WD	9.2(34.9)
4WD	9.2(34.9)
Pump Pressure in Psi(Bar)	
2WD	2,100(144.8)
4WD	2,500(172.4)
Turns to Lock	
2WD	3.4
4WD	4.7

**OPERATOR'S AREA**

Operating Noise in dB(A)	INA
Glass Area in SqFt(SqM)	62(5.77)
Heating System Capacity in Btu/Hr	INA
Cooling System Capacity in Btu/Hr	INA
Instrumentation Panel	analog analog, 2 gauges w/ 1 LCD or 3 gauges, 15 indicator lamps
Warning Lights	tachometer / hr. meter, fuel, temperature, & pto
Performance Monitor	

Mirror Visibility	1 rear, 2 side
Number of Doors and Windows	2 & 3
Number of Worklights	3 rops, 6 cab
Cab Mounting	rubber isolated

**CAPACITIES**

Fuel Tank in Gal(L)	34 or 42(129-160)
Engine Oil with Filter in Gal(L)	3.01(11.4)
Cooling System in Gal(L)	3.7-4.2(14-16)
Transmission/Axle in Gal(L)	15-17.4(56.8-66)
4WD Differential Case Qt(L)	1.64(6.2)

**DIMENSIONS**

NEW HOLLAND  
TS110 (90 Hp PTO)

## CAPACITIES (Cont.)

## Height

## Height to Top of Cab in In(Mm)

2WD 106.8(2,712.7)

4WD 106.8(2,712.7)

## Height to Top of Rops in In(Mm)

2WD 113.7(2,889)

4WD 113.7(2,889)

## Height to Top of Exhaust in In(Mm)

2WD 111.5(2,832)

4WD 111.5(2,832)

## Ground Clearance at Drawbar

## In In(Mm)

2WD 15.0(381)

4WD 15.0(381)

## Front Axle Clearance in In(Mm)

2WD 21.5(546)

4WD 17.7(450)

## Length

## Length to Lower Links in In(Mm)

2WD 150.2(3,815)

4WD 158.9(4,037)

## Wheelbase in In(Mm)

2WD 92.1(2,340)

4WD 93.0(2,362)

## Width

## Overall Width in In(Mm)

2WD 76.9-96.6(1,954-2,454)

4WD 76.9-96.6(1,954-2,454)

## Front Wheel Track Setting in In(Mm)

2WD 56.6-89.5(1,426-3,373)

4WD 55.6-83.7(1,413-2,127)

## Rear Wheel Track Setting in In(Mm)

Manual Adjust 56.1-79.8(1,425-2,027)

Power Adjust 56-80(1,422.4-2,032)

## Weight

## Tractor Rops Unit in Lb(Kg)

## Front Axle

2WD 2,511(1,130)

4WD 3,400(1,530)

## Rear Axle

2WD 4,856(2,185)

4WD 4,989(2,245)

## Total

2WD 7,367(3,315)

**DIMENSIONS (Cont.)**

4WD	8,389(3,775)
Tractor Cab Unit in in(Kg)	
Front Axle	
2WD	2,889(1,300)
4WD	4,044(1,820)
Rear Axle	
2WD	5,889(2,650)
4WD	6,156(2,770)
Total	
2WD	8,778(3,950)
4WD	10,200(4,590)
Turning Radius	
With Brakes in in(Mm)	
2WD	129(3,277)
4WD	136(3,454)
Without Brakes in in(Mm)	
2WD	144(3,660)
4WD	159(4,040)
Standard Tire Sizes	
2WD Front Wheels	7.5 x 16
4WD Front Wheels	13.6 x 24
Rear Wheels	16.9 x 34



March 18, 1999

PITTSBURG TRACTOR, INC.  
1893 State Hwy 271 N.  
Pittsburg, Texas 75686  
903-856-6548

Commissioner's Court of Titus County Texas

We are pleased to quote you the following prices for the two new tractors you are purchasing. We are quoting both an 88hp and a 98 hp tractor for you to choose from. If you have any questions, please call me.

Thank you for the opportunity to quote this equipment, we hope to be honored with your business.

Sincerely,

  
Larry Shrum  
President

**TRACTOR SPECIFICATIONS**

**4WHEEL DRIVE M-110 KUBOTA**

<b>ENGINE</b>	<b>5 CYLINDER TURBOCHARGED 88 PTO HP 356 CID</b>
<b>TRANSMISSION</b>	<b>24 FORWARD, 24 REVERSE, CLUTCHLESS SHUTTLE SHIFT WET DISC POWERSHIFT</b>
<b>PTO</b>	<b>540/1000 INDEPENDENT LEVER CONTROL</b>
<b>HYDRAULICS</b>	<b>3 POINT HITCH, DUAL VALVES, LEVER CONTROLLED, 20.6 GPM PUMP</b>
<b>STEERING</b>	<b>HYDROSTATIC POWER STEERING</b>
<b>CAB</b>	<b>AIR CONDITIONED, RADIO/HEATER</b>
<b>TIRES</b>	<b>(4WHEEL DRIVE) 14.9 x 24 FRONT RADICAL 18.4 x 34 REAR RADICAL WITH POWER ADJUST WHEEL WITH WEIGHTED CENTERS</b>
<b>SELLING PRICE: \$ 40,279,000</b>	

**4 WHEEL DRIVE M-120 KUBOTA**

<b>ENGINE</b>	<b>5 CYLINDER TURBOCHARGED 98 PTO 356 CID</b>
<b>TRANSMISSION</b>	<b>24 FORWARD, 24 REVERSE, CLUTCHLESS SHUTTLE WET DISC CLUTCH POWERSHIFT</b>
<b>PTO</b>	<b>540/1000 INDEPENDENT LEVER CONTROL</b>
<b>HYDRAUCLICS</b>	<b>3 POINT HITCH, DUAL VALVES, LEVER CONTROL, 20.6 GPM PUMP</b>
<b>STEERING</b>	<b>HYDROSTATIC POWER STEERING</b>
<b>CAB</b>	<b>AIR CONDITIONED, RADIO/HEATER</b>
<b>TIRES</b>	<b>(4 WHEEL DRIVE) FRONT 14.9 x 24 REAR 18.4 x 38 RADICAL, POWER ADJUST WHEEL WITH WEIGHTED CENTERS</b>
<b>SELLING PRICE: \$ 44,000.00</b>	

## TRACTOR SPECIFICATIONS

## 2 WHEEL DRIVE M-110 KUBOTA

ENGINE 5 CYLINDER TURBOCHARGED 88 PTO HP 356 CID  
TRANSMISSION 24 FORWARD, 24 REVERSE, CLUTCHLESS SHUTTLE  
SHIFT WET DISC POWERSHIFT  
PTO 540/1000 INDEPENDENT LEVER CONTROL  
HYDRAULICS 3 POINT HITCH, DUAL VALVES, LEVER CONTROLLED, 20.6  
GPM PUMP  
STEERING HYDROSTATIC POWER STEERING  
CAB AIR CONDITIONED, RADIO/HEATER  
TIRES (2 WHEEL DRIVE) 10.00 x 16 FRONT RADICAL  
18.4 x 34 REAR RADICAL WITH POWER  
ADJUST WHEEL WITH WEIGHTED CENTERS  
SELLING PRICE: \$ 35,750.00

## 2 WHEEL DRIVE M-120 KUBOTA

ENGINE 5 CYLINDER TURBOCHARGED 98 PTO 356 CID  
TRANSMISSION 24 FORWARD, 24 REVERSE, CLUTCHLESS SHUTTLE WET DISC  
CLUTCH POWERSHIFT  
PTO 540/1000 INDEPENDENT LEVER CONTROL  
HYDRAULICS 3 POINT HITCH, DUAL VALVES, LEVER CONTROL, 20.6 GPM  
PUMP  
STEERING HYDROSTATIC POWER STEERING  
CAB AIR CONDITIONED, RADIO/HEATER  
TIRES (2 WHEEL DRIVE) FRONT 10.00 x 16  
REAR 18.4 x 34 RADICAL, POWER ADJUST  
WHEEL WITH WEIGHTED CENTERS  
SELLING PRICE: \$ 39,125.00

VOL 26 PAGE 112RESOLUTION RE: STATE OF TEXAS  
"BLUE WARRANT" REQUIREMENTS  
AND THEIR COST TO TITUS COUNTY\*  
\*  
\*  
\*PROCEEDINGS BEFORE THE  
COMMISSIONERS COURT  
TITUS COUNTY  
APRIL 12, 1999

The Commissioner's Court of Titus County, Texas meeting in session the 12th day of April, 1999 considered the following resolution:

WHEREAS, The State of Texas issues arrest warrants ("blue warrants") for parole violators, and the Elected Sheriff of Titus County and his Deputies are required to arrest, transport, detain, house, feed, provide for the medical welfare and care for these State of Texas parole violators: and,

WHEREAS, The Elected Sheriff of Titus County and his Deputies are required to detain, house, feed, provide for the medical welfare and care for these State of Texas parole violators for as long as 183 days: and,

WHEREAS, The citizens and taxpayers of Titus County are thereby forced to fund the arrest, transportation, detention, housing, feeding, medical welfare and care of these State of Texas parole violators: and,

WHEREAS, This requirement to arrest, detain, house, feed, provide for the medical welfare and care for these State of Texas parole violators amounts to an unfunded mandate that creates a severe financial burden on the citizens and taxpayers of Titus County: and,

WHEREAS, The State of Texas has deemed that Titus County is not eligible for reimbursement for the expenses incurred in the arrest, transportation, detention, housing, feeding, provision of medical welfare and care of these State of Texas parole violators: and,

WHEREAS, In addition to all of the above, the citizens and taxpayers of Titus County are thereby forced to provide hearing rooms and facilities for The State of Texas to provide parole hearings for these State of Texas parole violators.

NOW THEREFORE BE IT RESOLVED, by the Commissioner's Court of the County of Titus, Texas, hereby requests that the Legislature of The State of Texas, meeting in it's 76th session, in Austin, Texas to change the requirements to allow Titus County to be reimbursed at the rate of \$35.00 per day for the arrest, transportation, detention, housing, feeding, and care of these parole violators on behalf of the State of Texas, or allow these parole violators to be immediately placed in a state facility.

DONE IN OPEN COURT, THIS 12th day of April, 1999, upon motion by

Mike Price, seconded by Thomas E. Hockaday, and all.

members of the court being present and voting "aye".

Danny P. Crooks  
DANNY PAT CROOKS, COUNTY JUDGE

Mike Price  
MIKE PRICE, COMMISSIONER  
Precinct 1

Bill Jack Thompson  
BILL JACK THOMPSON, COMMISSIONER  
Precinct 3

Mike Fields  
MIKE FIELDS, COMMISSIONER  
Precinct 2

Thomas E. Hockaday  
THOMAS HOCKADAY, COMMISSIONER  
Precinct 4

FIRST SUPPLEMENT TO INMATE PAY TELEPHONE AGREEMENT

THIS FIRST SUPPLEMENT TO INMATE TELEPHONE SYSTEM AGREEMENT is entered into effect as of the 5 day of May, 1999 by and between Evercom Systems, Inc. ("ESI") and Titus County, Texas (collectively, the "County").

WHEREAS, E.S.I. and Titus County, Texas desire to supplement the Agreement as herein set forth.

1. Evercom agrees to provide the County with a license to use one or more items of the LEMS Software Line (collectively, the "LEMS Software") and computer hardware utilized with the LEMS Software (the "Related Equipment"), all as more particularly described below. The Related Equipment shall be installed by Evercom within sixty days following the execution of this Agreement by both parties.

Related LEMS Equipment:

- 14 Computers (This includes the 3 for DPS)
- 4 Compaq Laptops with Ethernet Connections
  - 2-With 64 mg ram
  - 2 With 32 mg ram
- 4 Docking Stations for Laptops
- 7 Network Cards for IBM ThinkPad Laptops
- 1 Black/White Printer for DPS
- 2 Black/White Printers for Jail and Sheriff's Office
- 1 Citizens PN#50 Printer
- 1 Monitor and Keyboard for IBM ThinkPad
- 1 Server Upgrade to 50 User
- 1 Share Software 1 Adobe Work Shop Software
- 1 Sony Mavica Camera
- 1 Writable CD Rom for Crime Scene
- 1 New Video Imaging Camera
- 1 Lighting Source
  - (Fiber Optic Information if Available)
2. In consideration of the aforementioned LEMS Software and Related Equipment, Titus County will extend the current contract until November 2002.

EXECUTED and Incorporated as a part of the Inmate Pay Telephone Agreement dated the 19<sup>th</sup> day of April, 1999 by and between Titus County, Texas and Evercom Systems, Inc. ("ESI").

Evercom Systems, Inc.  
8201 Tristar Drive  
Irving, Texas 75063

Name: C. Dargatzidis  
Title: Director - Marketing Sales  
Date: 5-4-99

Titus County  
304 S. Van Buren  
Mt. Pleasant, Texas 75455

Name: Danny Pat Coker  
Title: Co. Judge  
Date: April 22, 1999

County Name, State: **Titus County, TX**  
 Sales Person: **R. Ferguson** Date: **January 19, 1998**

**L.E.M.S. Installation Survey**

Type of system (Choose One) (Mark With \*)  
☐ Stand Alone Imaging Station  
☒ Multi-User  
☐ New System  
☒ Upgrade Existing LEMS System

**L.E.M.S. Hardware Requirements**

Network OS (Choose one) (Mark With \*)  
☒ File Server  
☐ 5 User  
☐ 25 User  
☐ 10 User  
☒ 50 User  
☐ Use Existing  
☒ New Wiring

☒ Capture Station(s) (Choose One) (Mark With \*)  
☐ External Capture System (Sony Mavica)  
☒ Integrated Capture System (recommended)

☒ Additional Work Station(s) (Basic)  
☐ Additional Work Station(s) (Specify) ☐ Sound Card w/ Speakers  
☐ Additional Modems ☐ Other

☒ Laptop Computer ☒ Docking Station ☒ Nylon Carrying Case  
☐ External 17" Monitor ☐ Car Power Adapter ☒ External Keyboard and Mouse  
☒ Laptop Network Adapter

☒ B/W Laser - Professional 12ppm, 600dpi, \$0.01 ppc (Cost)  
☐ B/W Laser - Office Type 8ppm, 600dpi, \$0.04 ppc (Cost)  
☐ Color Ink Jet - 1440 x 720 dpi, 4ppm

☐ Bar Code Scanners (wireless)  
☐ Barcode Downloader

☐ Bar Code Scanners (PC connected)

☒ Portable Digital Camera

LEMS Cost Only **\$59,585.00**

**Other Hardware**

<input checked="" type="checkbox"/> Xircom Network Adaptors	Cost: \$1,750.00
<input type="checkbox"/> Monitor, Keyboard and Mice for IBM laptop	Cost: \$600.00
<input type="checkbox"/> CD-Rewriter	Cost: \$625.00
<input type="checkbox"/> Misc. Hardware (HUBS, Wire, ect.)	Cost: \$1,500.00
<input type="checkbox"/>	Cost:

Total Hardware: **\$4,475.00**

**L.E.M.S. Software Requirements**

☐ Jail Management System  
☐ Records Management System

**Non - L.E.M.S. Software Requirements**

<input checked="" type="checkbox"/> I Share Software	Cost: \$265.00
<input checked="" type="checkbox"/> Adobe Photoshop Software	Cost: \$125.00
<input type="checkbox"/>	Cost:

Total Software: **\$390.00**

Grand Total: **\$64,450.00**

Upgrade for year 2000 +4,275.00

**\$68,725.00**

APPLICATION FOR PERMIT

TO: COMMISSIONERS COURT  
Mt. Pleasant, Texas 75455

Application is hereby made by Southwestern Bell Telephone Company  
for permission to lay buried line along/under that certain segment of the  
county road in Precinct # three (3) at the following location(s):

*Place + hole across + along HE CR32  
as shown on attached drawings.*

Respectfully submitted,

C. D. Prince 3-10-99  
Manager-Engineer Design Date  
307 N. Van Buren  
Mt. Pleasant, Texas 75455  
(903)572-3495

APPROVED DENIED

Danny P. Link 04-12-99  
COUNTY JUDGE Date

4646210

WORK LOCATION

The Hits Just  
Keep Coming

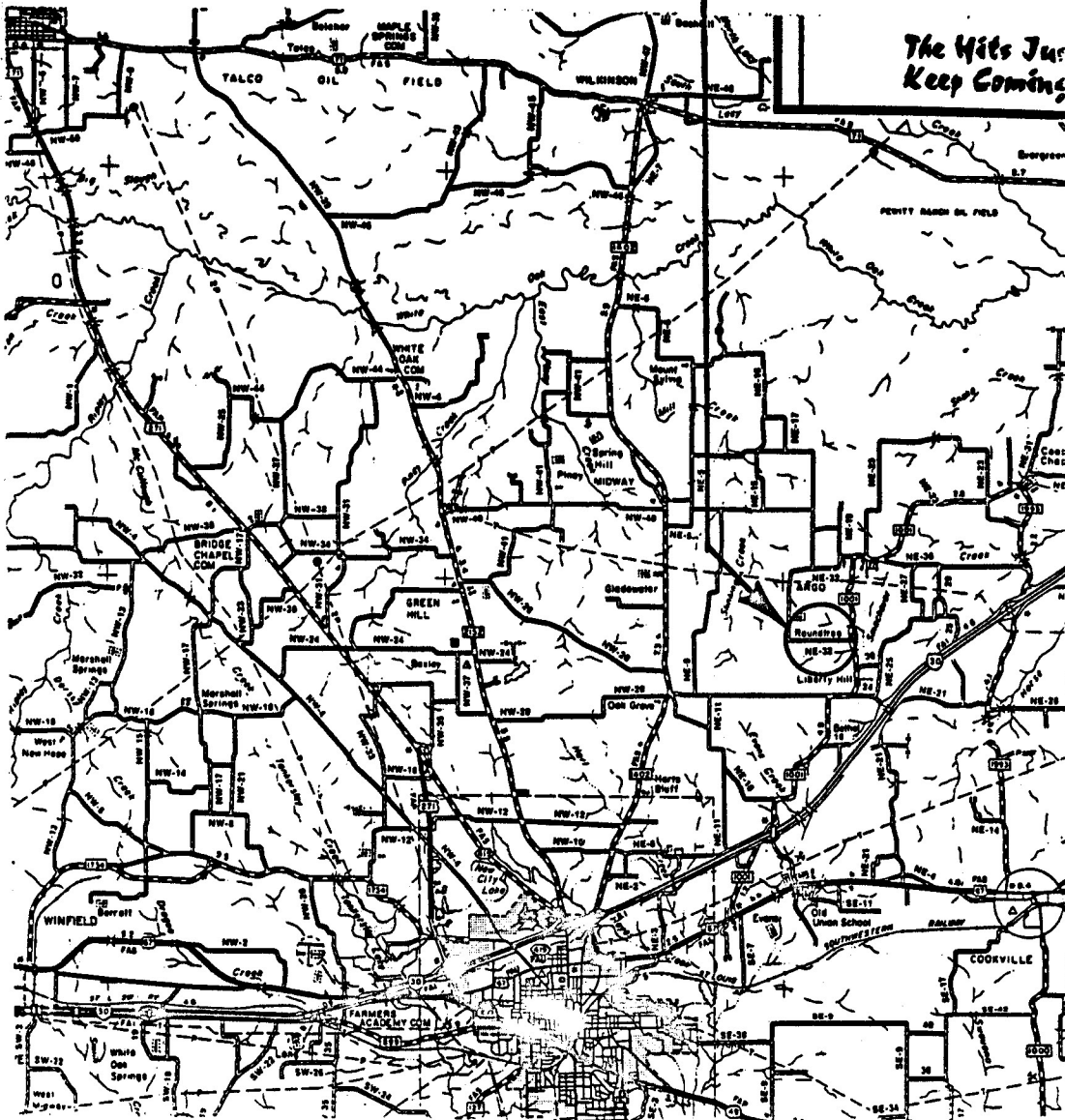



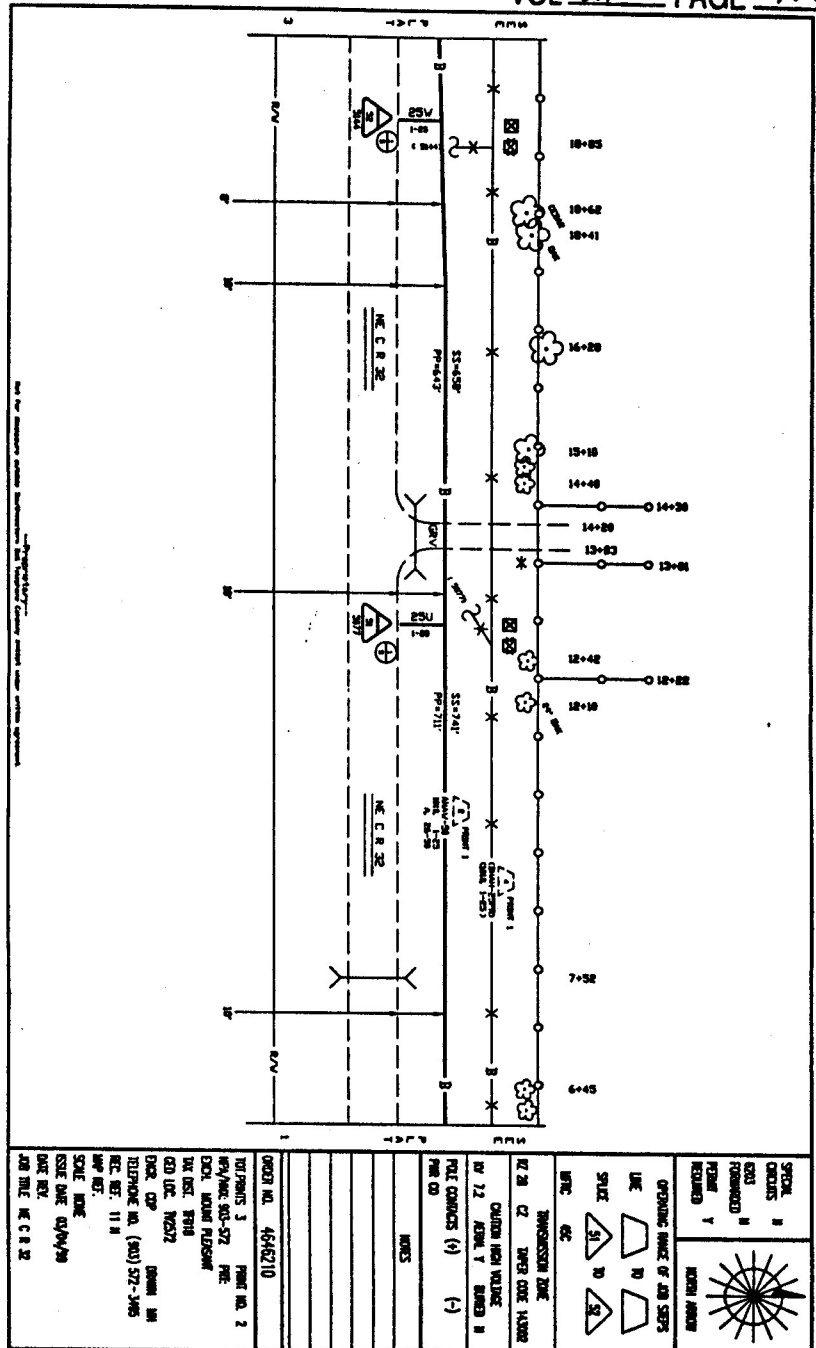





4650554

1-7

APPLICATION FOR PERMIT

TO: COMMISSIONERS COURT  
Mt. Pleasant, Texas 75455

Application is hereby made by Southwestern Bell Telephone Company  
for permission to lay buried line along/under that certain segment of the  
county road in Precinct # Four (4) at the following location(s):

*Place 4 poles across along  
SECR 15 as shown on attached  
drawings.*

Respectfully submitted,

C.D. Prince 3-24-99  
Manager-Engineer Design Date  
307 N. Van Buren  
Mt. Pleasant, Texas 75455  
(903)572-3495

APPROVED DENIED

Danny Smith 04-12-99  
COUNTY JUDGE Date

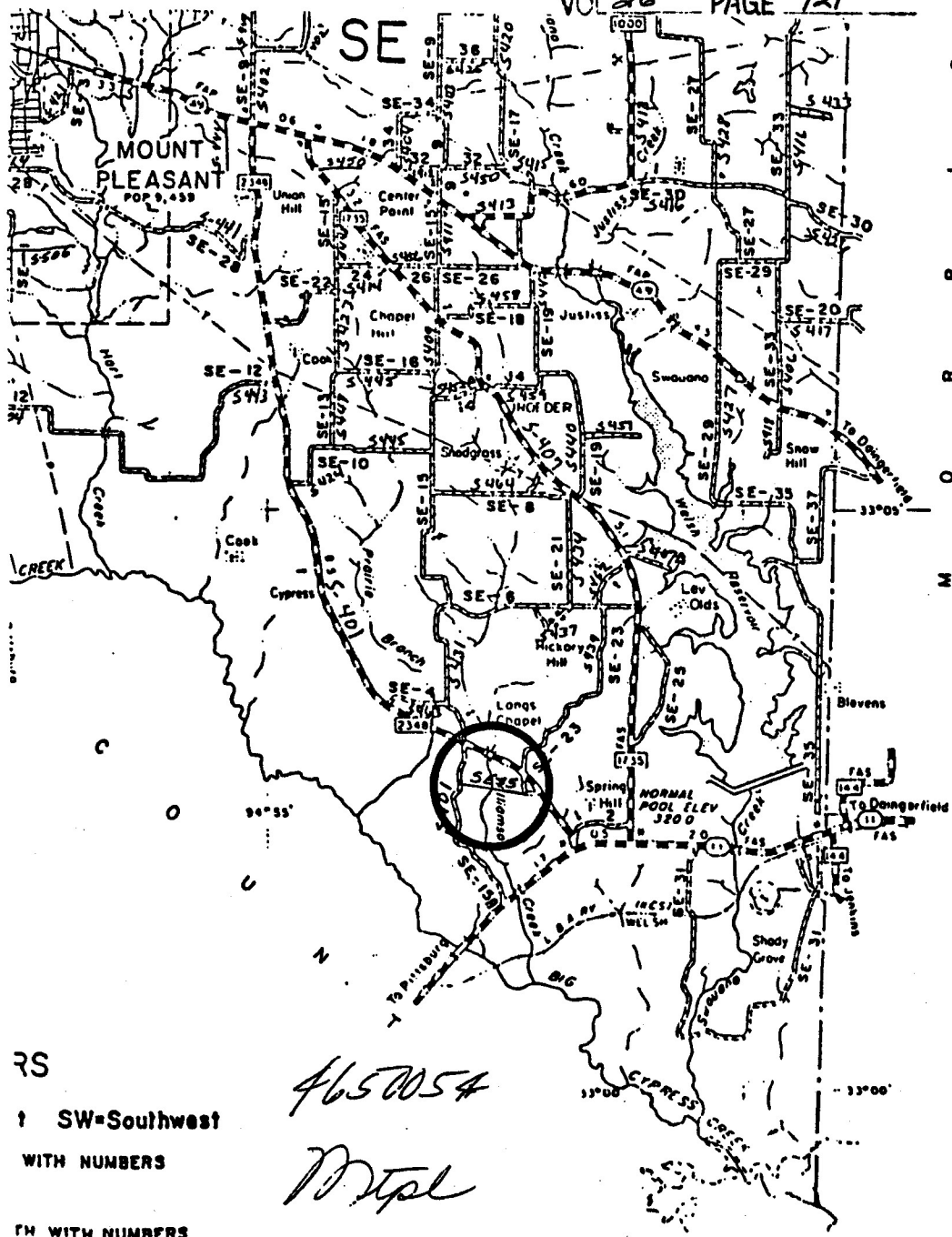

RS

SW=Southwest

WITH NUMBERS

FM WITH NUMBERS

465054

Mtpl



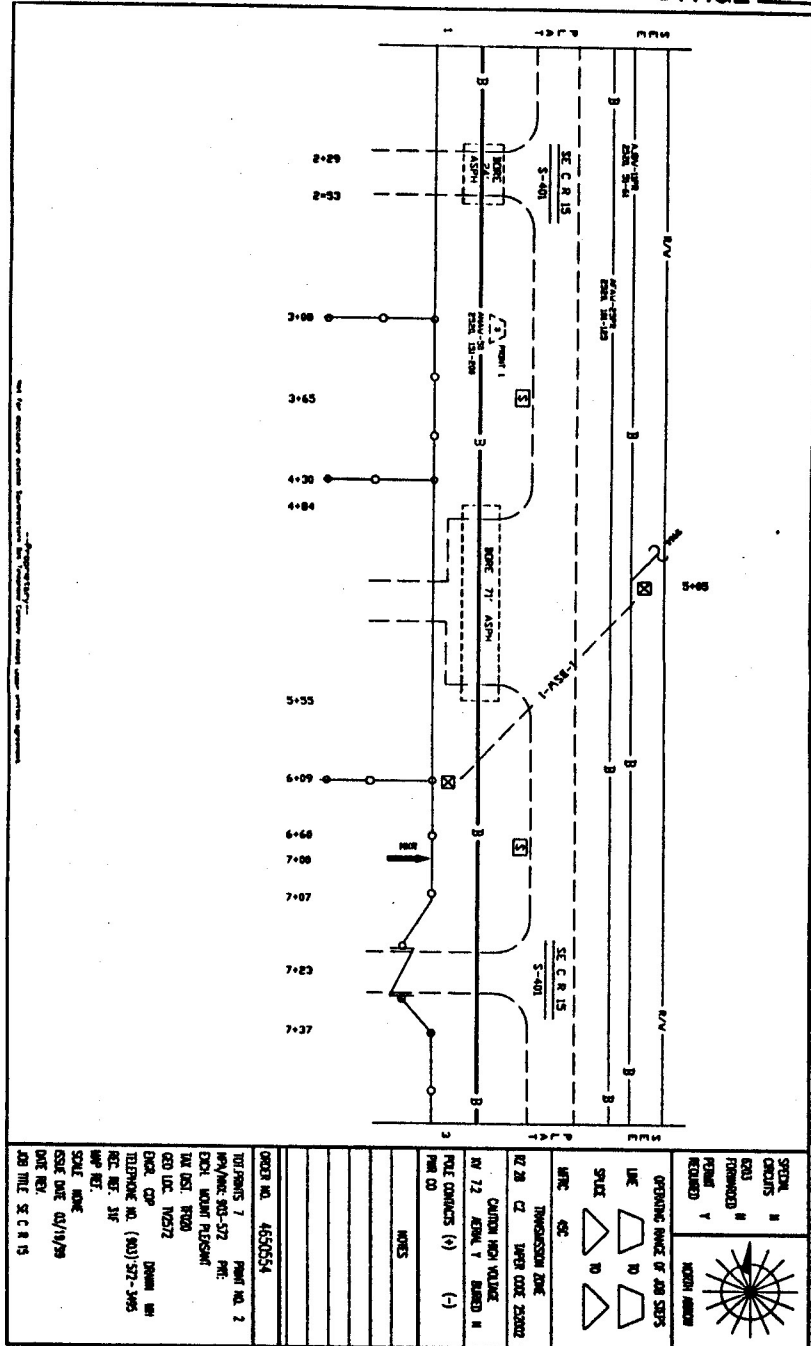

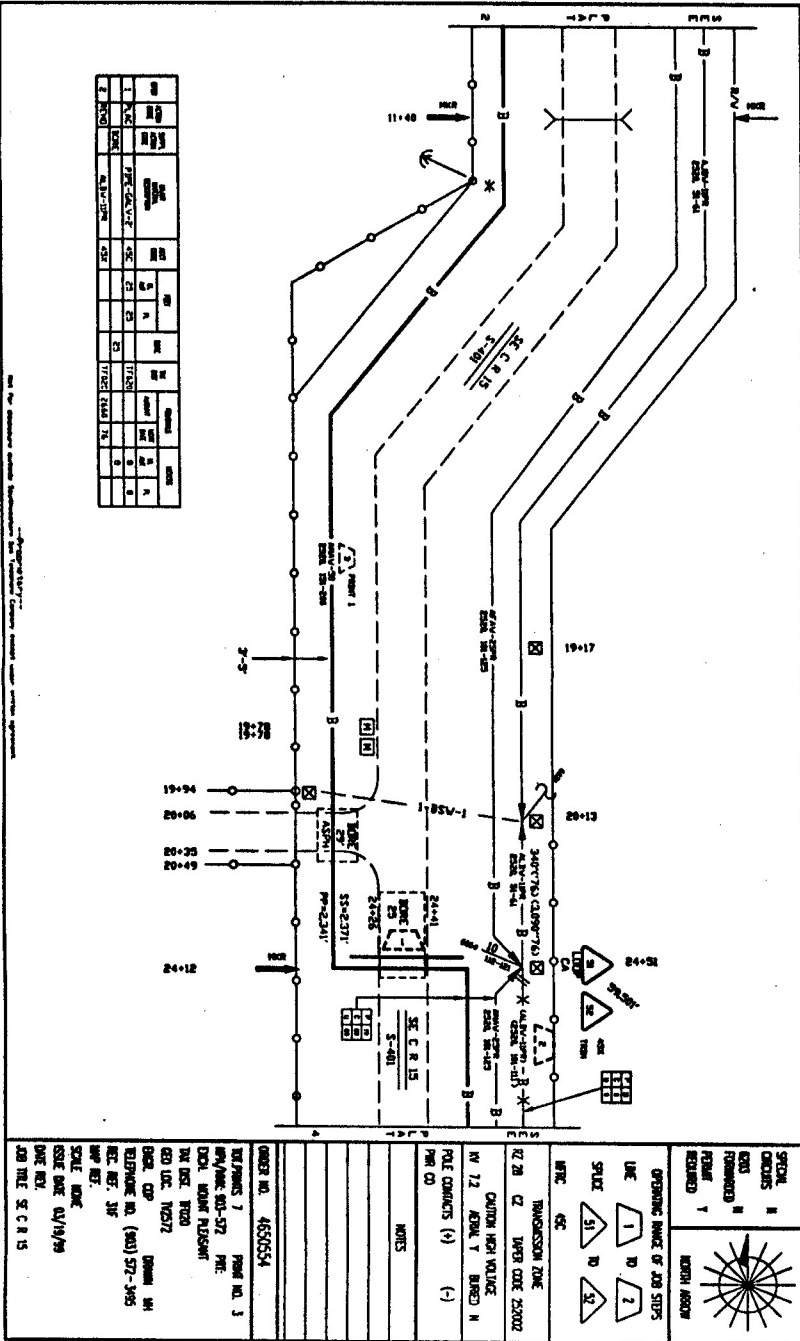





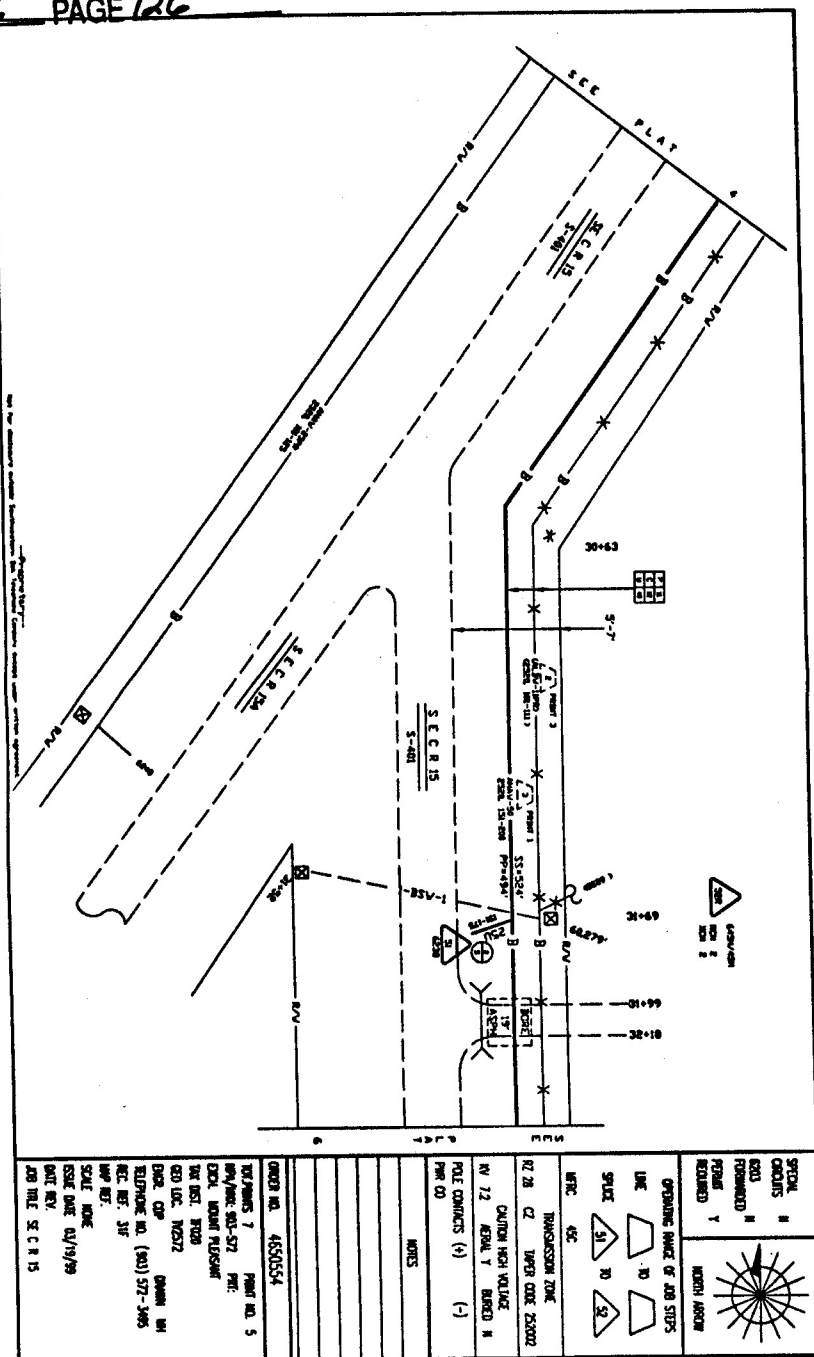

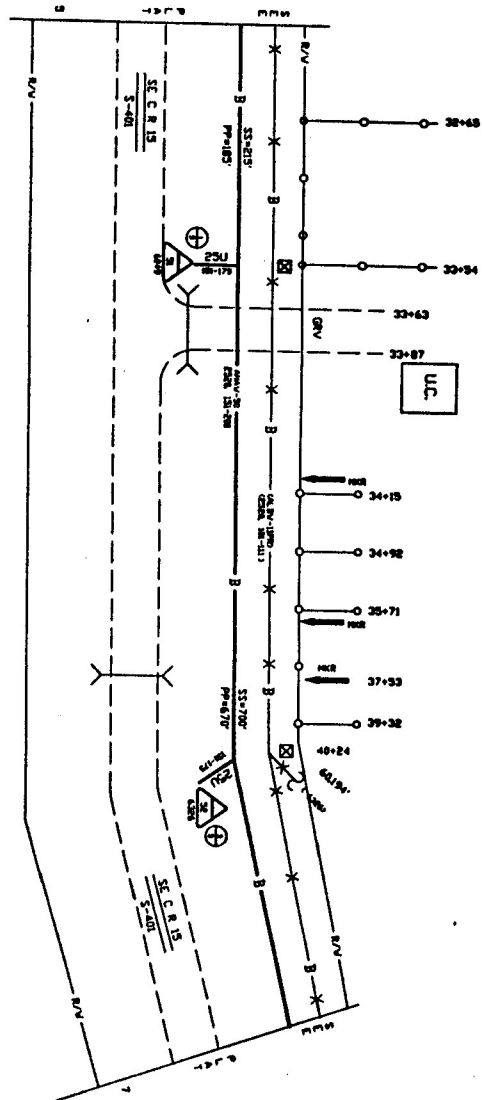

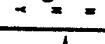



STATION	N	COORDINATES	N	FORWARDED	N	RECORDED	Y	
OPERATING INVOICE OF JOB SLOTS								NORTH ARROW
LINE		TO						
SPACE		TO						
WTRC 45C								
TRANSMISSION ZONE								
RT 28	C2	TAPER CODE 230002						
CAUTION HIGH VOLTAGE								
RT 72	KERNAL Y	BUNDLED N						
POLE CONTACTS (+) (-)								
PER CO								
NOTES								
ORDER NO. 4650554								
107 PAYS 7				PRINT NO. 6				
HW PHONE NO. 502-572				PRT:				
ECHL MOUNT FLESHMATT								
TA 051. 78200								
CBL LOC. 12622								
BGR. CDP DRYMAN WA								
TELEPHONE NO. (800) 577-3865								
REC. REF. SIF								
MAP REF:								
SCALE NONE								
ISSUE DATE 04/19/99								
DATE REV.								
JOB TITLE SE C R 15								

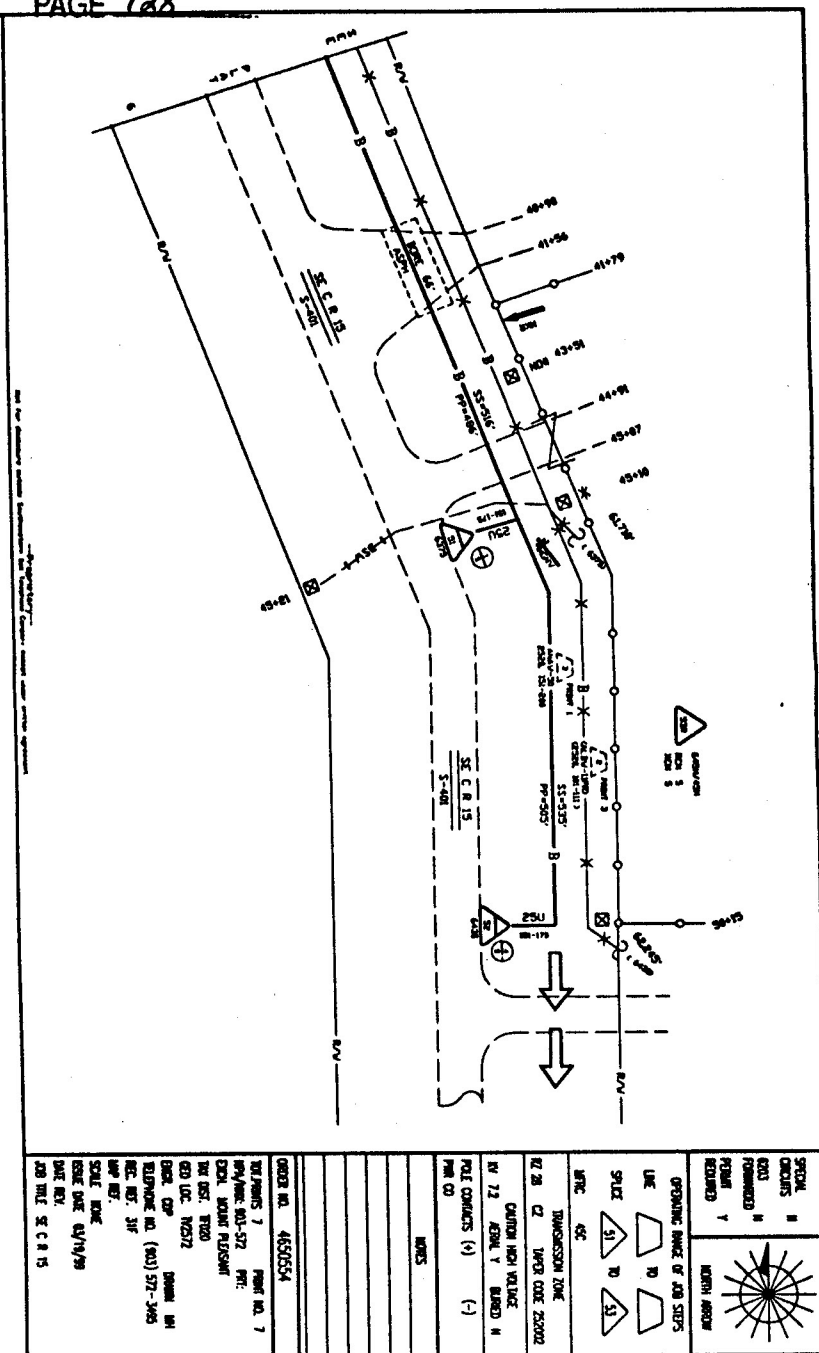

4657258

## APPLICATION FOR PERMIT

TO: COMMISSIONERS COURT  
Mt. Pleasant, Texas 75455

Application is hereby made by Southwestern Bell Telephone Company  
for permission to lay buried line along/under that certain segment of the  
county road in Precinct # three (3) at the following location(s):

*Place + line along NE CR 36  
as shown on attached drawings.*

Respectfully submitted,

C. D. Prince      3-29-99  
Manager-Engineer Design      Date  
307 N. Van Buren  
Mt. Pleasant, Texas 75455  
(903)572-3495

APPROVED - DENIED

Denny Plank      04-12-99  
COUNTY JUDGE      Date

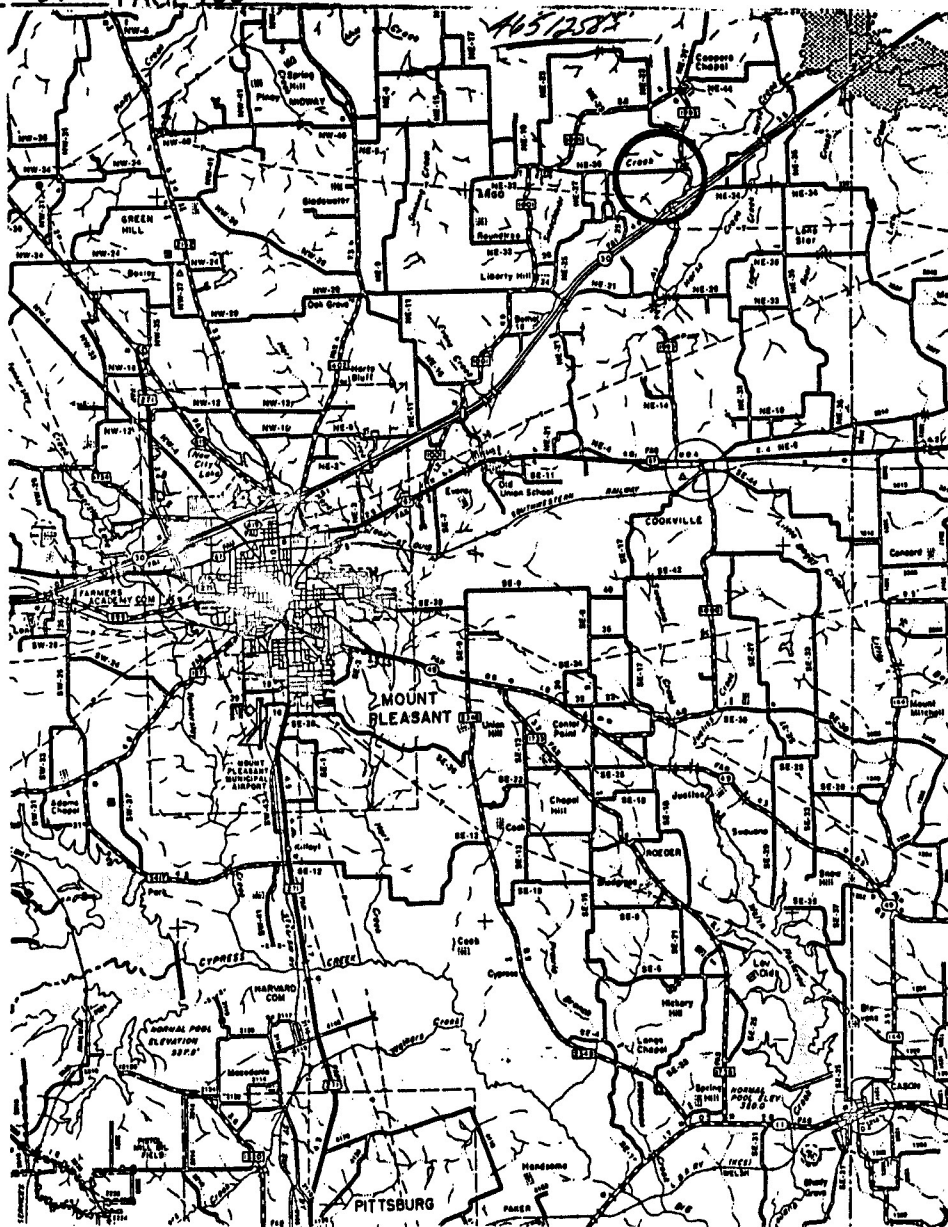



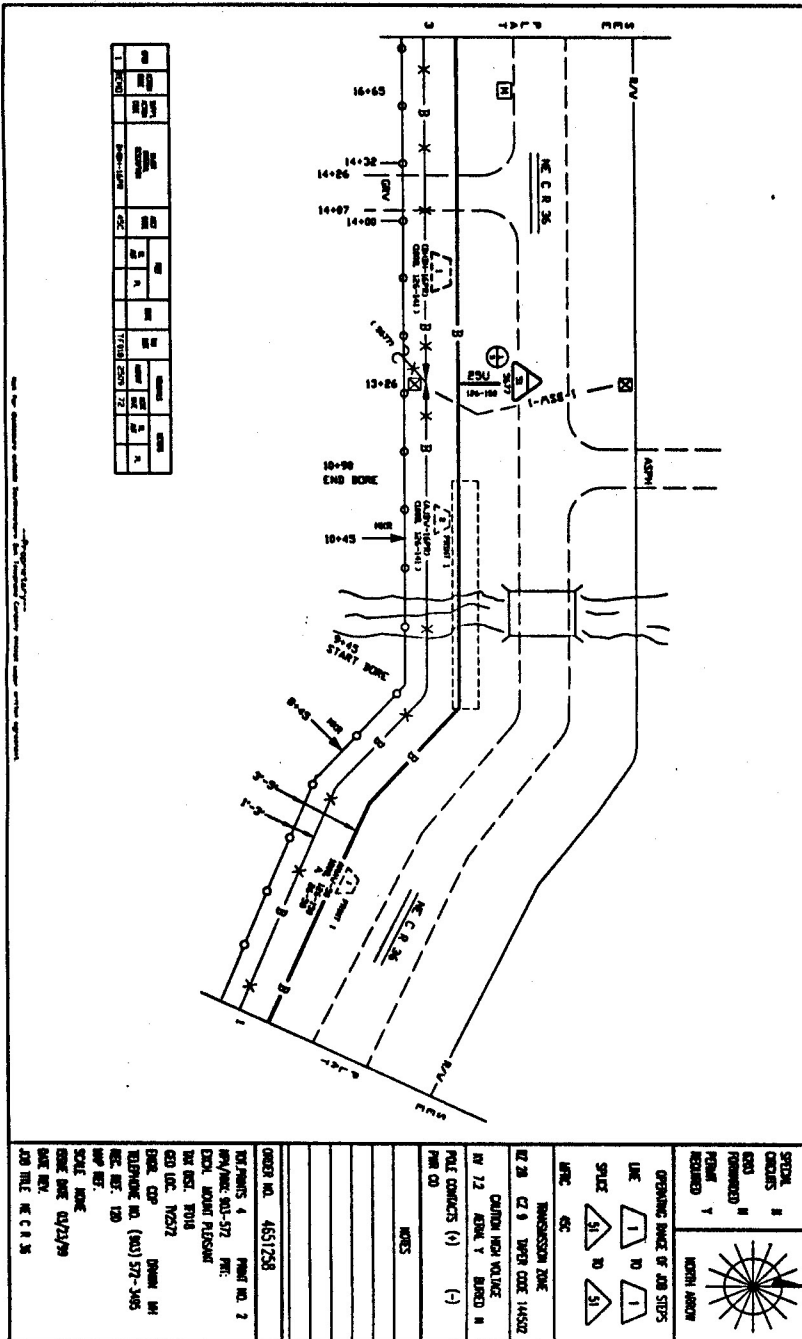

NO.	DATE	BY	CHKD.	APP'D.	REVISION
1	10/10/99	WJ	WJ	WJ	1.00
2	11/03/99	WJ	WJ	WJ	1.01
3	11/03/99	WJ	WJ	WJ	1.02
4	11/03/99	WJ	WJ	WJ	1.03
5	11/03/99	WJ	WJ	WJ	1.04
6	11/03/99	WJ	WJ	WJ	1.05
7	11/03/99	WJ	WJ	WJ	1.06
8	11/03/99	WJ	WJ	WJ	1.07
9	11/03/99	WJ	WJ	WJ	1.08
10	11/03/99	WJ	WJ	WJ	1.09
11	11/03/99	WJ	WJ	WJ	1.10
12	11/03/99	WJ	WJ	WJ	1.11
13	11/03/99	WJ	WJ	WJ	1.12
14	11/03/99	WJ	WJ	WJ	1.13
15	11/03/99	WJ	WJ	WJ	1.14
16	11/03/99	WJ	WJ	WJ	1.15
17	11/03/99	WJ	WJ	WJ	1.16
18	11/03/99	WJ	WJ	WJ	1.17
19	11/03/99	WJ	WJ	WJ	1.18
20	11/03/99	WJ	WJ	WJ	1.19
21	11/03/99	WJ	WJ	WJ	1.20
22	11/03/99	WJ	WJ	WJ	1.21
23	11/03/99	WJ	WJ	WJ	1.22
24	11/03/99	WJ	WJ	WJ	1.23
25	11/03/99	WJ	WJ	WJ	1.24
26	11/03/99	WJ	WJ	WJ	1.25
27	11/03/99	WJ	WJ	WJ	1.26
28	11/03/99	WJ	WJ	WJ	1.27
29	11/03/99	WJ	WJ	WJ	1.28
30	11/03/99	WJ	WJ	WJ	1.29
31	11/03/99	WJ	WJ	WJ	1.30
32	11/03/99	WJ	WJ	WJ	1.31
33	11/03/99	WJ	WJ	WJ	1.32
34	11/03/99	WJ	WJ	WJ	1.33
35	11/03/99	WJ	WJ	WJ	1.34
36	11/03/99	WJ	WJ	WJ	1.35
37	11/03/99	WJ	WJ	WJ	1.36
38	11/03/99	WJ	WJ	WJ	1.37
39	11/03/99	WJ	WJ	WJ	1.38
40	11/03/99	WJ	WJ	WJ	1.39
41	11/03/99	WJ	WJ	WJ	1.40
42	11/03/99	WJ	WJ	WJ	1.41
43	11/03/99	WJ	WJ	WJ	1.42
44	11/03/99	WJ	WJ	WJ	1.43
45	11/03/99	WJ	WJ	WJ	1.44
46	11/03/99	WJ	WJ	WJ	1.45
47	11/03/99	WJ	WJ	WJ	1.46
48	11/03/99	WJ	WJ	WJ	1.47
49	11/03/99	WJ	WJ	WJ	1.48
50	11/03/99	WJ	WJ	WJ	1.49
51	11/03/99	WJ	WJ	WJ	1.50
52	11/03/99	WJ	WJ	WJ	1.51
53	11/03/99	WJ	WJ	WJ	1.52
54	11/03/99	WJ	WJ	WJ	1.53
55	11/03/99	WJ	WJ	WJ	1.54
56	11/03/99	WJ	WJ	WJ	1.55
57	11/03/99	WJ	WJ	WJ	1.56
58	11/03/99	WJ	WJ	WJ	1.57
59	11/03/99	WJ	WJ	WJ	1.58
60	11/03/99	WJ	WJ	WJ	1.59
61	11/03/99	WJ	WJ	WJ	1.60
62	11/03/99	WJ	WJ	WJ	1.61
63	11/03/99	WJ	WJ	WJ	1.62
64	11/03/99	WJ	WJ	WJ	1.63
65	11/03/99	WJ	WJ	WJ	1.64
66	11/03/99	WJ	WJ	WJ	1.65
67	11/03/99	WJ	WJ	WJ	1.66
68	11/03/99	WJ	WJ	WJ	1.67
69	11/03/99	WJ	WJ	WJ	1.68
70	11/03/99	WJ	WJ	WJ	1.69
71	11/03/99	WJ	WJ	WJ	1.70
72	11/03/99	WJ	WJ	WJ	1.71
73	11/03/99	WJ	WJ	WJ	1.72
74	11/03/99	WJ	WJ	WJ	1.73
75	11/03/99	WJ	WJ	WJ	1.74
76	11/03/99	WJ	WJ	WJ	1.75
77	11/03/99	WJ	WJ	WJ	1.76
78	11/03/99	WJ	WJ	WJ	1.77
79	11/03/99	WJ	WJ	WJ	1.78
80	11/03/99	WJ	WJ	WJ	1.79
81	11/03/99	WJ	WJ	WJ	1.80
82	11/03/99	WJ	WJ	WJ	1.81
83	11/03/99	WJ	WJ	WJ	1.82
84	11/03/99	WJ	WJ	WJ	1.83
85	11/03/99	WJ	WJ	WJ	1.84
86	11/03/99	WJ	WJ	WJ	1.85
87	11/03/99	WJ	WJ	WJ	1.86
88	11/03/99	WJ	WJ	WJ	1.87
89	11/03/99	WJ	WJ	WJ	1.88
90	11/03/99	WJ	WJ	WJ	1.89
91	11/03/99	WJ	WJ	WJ	1.90
92	11/03/99	WJ	WJ	WJ	1.91
93	11/03/99	WJ	WJ	WJ	1.92
94	11/03/99	WJ	WJ	WJ	1.93
95	11/03/99	WJ	WJ	WJ	1.94
96	11/03/99	WJ	WJ	WJ	1.95
97	11/03/99	WJ	WJ	WJ	1.96
98	11/03/99	WJ	WJ	WJ	1.97
99	11/03/99	WJ	WJ	WJ	1.98
100	11/03/99	WJ	WJ	WJ	1.99
101	11/03/99	WJ	WJ	WJ	2.00
102	11/03/99	WJ	WJ	WJ	2.01
103	11/03/99	WJ	WJ	WJ	2.02
104	11/03/99	WJ	WJ	WJ	2.03
105	11/03/99	WJ	WJ	WJ	2.04
106	11/03/99	WJ	WJ	WJ	2.05
107	11/03/99	WJ	WJ	WJ	2.06
108	11/03/99	WJ	WJ	WJ	2.07
109	11/03/99	WJ	WJ	WJ	2.08
110	11/03/99	WJ	WJ	WJ	2.09
111	11/03/99	WJ	WJ	WJ	2.10
112	11/03/99	WJ	WJ	WJ	2.11
113	11/03/99	WJ	WJ	WJ	2.12
114	11/03/99	WJ	WJ	WJ	2.13
115	11/03/99	WJ	WJ	WJ	2.14
116	11/03/99	WJ	WJ	WJ	2.15
117	11/03/99	WJ	WJ	WJ	2.16
118	11/03/99	WJ	WJ	WJ	2.17
119	11/03/99	WJ	WJ	WJ	2.18
120	11/03/99	WJ	WJ	WJ	2.19
121	11/03/99	WJ	WJ	WJ	2.20
122	11/03/99	WJ	WJ	WJ	2.21
123	11/03/99	WJ	WJ	WJ	2.22
124	11/03/99	WJ	WJ	WJ	2.23
125	11/03/99	WJ	WJ	WJ	2.24
126	11/03/99	WJ	WJ	WJ	2.25
127	11/03/99	WJ	WJ	WJ	2.26
128	11/03/99	WJ	WJ	WJ	2.27
129	11/03/99	WJ	WJ	WJ	2.28
130	11/03/99	WJ	WJ	WJ	2.29
131	11/03/99	WJ	WJ	WJ	2.30
132	11/03/99	WJ	WJ	WJ	2.31
133	11/03/99	WJ	WJ	WJ	2.32
134	11/03/99	WJ	WJ	WJ	2.33
135	11/03/99	WJ	WJ	WJ	2.34
136	11/03/99	WJ	WJ	WJ	2.35
137	11/03/99	WJ	WJ	WJ	2.36
138	11/03/99	WJ	WJ	WJ	2.37
139	11/03/99	WJ	WJ	WJ	2.38
140	11/03/99	WJ	WJ	WJ	2.39
141	11/03/99	WJ	WJ	WJ	2.40
142	11/03/99	WJ	WJ	WJ	2.41
143	11/03/99	WJ	WJ	WJ	2.42
144	11/03/99	WJ	WJ	WJ	2.43
145	11/03/99	WJ	WJ	WJ	2.44
146	11/03/99	WJ	WJ	WJ	2.45
147	11/03/99	WJ	WJ	WJ	2.46
148	11/03/99	WJ	WJ	WJ	2.47
149	11/03/99	WJ	WJ	WJ	2.48
150	11/03/99	WJ	WJ	WJ	2.49
151	11/03/99	WJ	WJ	WJ	2.50
152	11/03/99	WJ	WJ	WJ	2.51
153	11/03/99	WJ	WJ	WJ	2.52
154	11/03/99	WJ	WJ	WJ	2.53
155	11/03/99	WJ	WJ	WJ	2.54
156	11/03/99	WJ	WJ	WJ	2.55
157	11/03/99	WJ	WJ	WJ	2.56
158	11/03/99	WJ	WJ	WJ	2.57
159	11/03/99	WJ	WJ	WJ	2.58
160	11/03/99	WJ	WJ	WJ	2.59
161	11/03/99	WJ	WJ	WJ	2.60
162	11/03/99	WJ	WJ	WJ	2.61
163	11/03/99	WJ	WJ	WJ	2.62
164	11/03/99	WJ	WJ	WJ	2.63
165	11/03/99	WJ	WJ	WJ	2.64
166	11/03/99	WJ	WJ	WJ	2.65
167	11/03/99	WJ	WJ	WJ	2.66
168	11/03/99	WJ	WJ	WJ	2.67
169	11/03/99	WJ	WJ	WJ	2.68
170	11/03/99	WJ	WJ	WJ	2.69
171	11/03/99	WJ	WJ	WJ	2.70
172	11/03/99	WJ	WJ	WJ	2.71
173	11/03/99	WJ	WJ	WJ	2.72
174	11/03/99	WJ	WJ	WJ	2.73
175	11/03/99	WJ	WJ	WJ	2.74
176	11/03/99	WJ	WJ	WJ	2.75
177	11/03/99	WJ	WJ	WJ	2.76
178	11/03/99	WJ	WJ	WJ	2.77
179	11/03/99	WJ	WJ	WJ	2.78
180	11/03/99	WJ	WJ	WJ	2.79
181	11/03/99	WJ	WJ	WJ	2.80
182	11/03/99	WJ	WJ	WJ	2.81
183	11/03/99	WJ	WJ	WJ	2.82
184	11/03/99	WJ	WJ	WJ	2.83
185	11/03/99	WJ	WJ	WJ	2.84
186	11/03/99	WJ	WJ	WJ	2.85
187	11/03/99	WJ	WJ	WJ	2.86
188	11/03/99	WJ	WJ	WJ	2.87
189	11/03/99	WJ	WJ	WJ	2.88
190	11/03/99	WJ	WJ	WJ	2.89
191	11/03/99	WJ	WJ	WJ	2.90
192	11/03/99	WJ	WJ	WJ	2.91
193	11/03/99	WJ	WJ	WJ	2.92
194	11/03/99	WJ	WJ	WJ	2.93
195	11/03/99	WJ	WJ	WJ	2.94
196	11/03/99	WJ	WJ	WJ	2.95
197	11/03/99	WJ	WJ	WJ	2.96
198	11/03/99	WJ	WJ	WJ	2.97
199	11/03/99	WJ	WJ	WJ	2.98
200	11/03/99	WJ	WJ	WJ	2.99
201	11/03/99	WJ	WJ	WJ	3.00
202	11/03/99	WJ	WJ	WJ	3.01
203	11/03/99	WJ	WJ	WJ	3.02
204	11/03/99	WJ	WJ	WJ	3.03
205	11/03/99	WJ	WJ	WJ	3.04
206	11/03/99	WJ	WJ	WJ	3.05
207	11/03/99	WJ	WJ	WJ	3.06
208	11/03/99	WJ	WJ	WJ	3.07
209	11/03/99	WJ	WJ	WJ	3.08
210	11/03/99	WJ	WJ	WJ	3.09
211	11/03/99	WJ	WJ	WJ	3.10
212	11/03/99	WJ	WJ	WJ	3.1





[illegible]