

Dear Sirs:

I propose to construct for you a 20' X 50' bridge, utilizing 2 railroad flat car bodies, with the following specifications: (1) 18" diameter reinforced concrete piers, 3 on each end (2) Minimum 12" W-beam steel caps (3) 5" channel steel form to contain paving (4) 5" channel steel guard rail, 18" to 24" high (5) 20" long headwalls and 6' to 8' long wingwalls constructed from 3/8" plate steel (6) Entire bridge structure decked with plate steel

Construction time: 15 to 20 working days Total job cost, turnkey: \$19,800.00

Terms of payment: (1) \$7,000.00 per flat-car upon delivery to jobsite (2) \$3,000.00 upon completion of piers, headwalls, and wingwalls (3) Balance upon completion of entire structure

I can begin construction of this bridge during the last week of March, or the first week of April, depending on my present construction schedule.

Looking forward to a continued fine relationship with you and your county, I am

Sincerely yours,  
 /s/ Bernard P. Hecars  
 Bernard P. Hecars

BPH/kih

IN THE MATTER OF  
 ADVERTISEMENT FOR BIDS

Motion by Commissioner Parr and seconded by Commissioner Parish to advertisement for bids for 1 ton truck for Fire Dept. Bids to be opened on April 10 at regular session. Motion carried.

SPECIAL SESSION  
 MARCH 16, 1978

BE IT REMEMBERED THAT THE TITUS COUNTY COMMISSIONERS COURT met in Special Session, Thursday, March 16, 1978, in the Titus County Courtroom with all members present.

- William Wayne Landrum
- C. H. Reese
- Bert Parr
- Alvin Parish, Jr.
- Bill Reynolds
- Allen LaPrade

- County Judge
- Commissioner Precinct 1
- Commissioner Precinct 2
- Commissioner Precinct 3
- Commissioner Precinct 4
- County Clerk

and the following proceedings were had to-wit:

The Titus County Commissioners Court met in Special Session, in Titus County Courtroom on Thursday March 16, 1978, to canvass the returns of the election held on March 11, 1978, to legalize the sale of beer at Millers Cove.

Motion by Commissioner Reese and seconded by Commissioner Parish to approve the Order as read and recorded in Commissioners Court Minutes Volume 10 Page 443. Motion carried.

ORDER OF ELECTION

On this 13th day of March, 1978, came on to be heard by the County Judge of Titus County, Texas, a petition praying that the said County Judge order an election to be held in the Harts Bluff Common School District to elect school trustees and to determine the following question:

"Shall Harts Bluff Common School District incorporate as an independent school district known as Harts Bluff Independent School District?"

After hearing said petition, the County Judge finds that the petition fulfills the requirements of section 19.202 of the Texas Education Code, that the facts contained therein are true, that all requirements of law for the calling of such election have been met and that said petition should be granted.

The judge further finds that a definite metes and bounds description of the common school district proposed to be incorporated is as follows:

- BEGINNING at the NE corner of the J. A. Seals, Abst. No. 535
- THENCE WEST with the NB line of Seals Survey 1000 vrs., continue West with NB line of D. McCall Survey 2000 vrs., continue on West for a total of 6250 vrs., a point 250 vrs. East of the EB line of the BBB & CRR Survey Abst. No. 79;
- THENCE North 1875 vrs. to the SW Corner of the J. J. Dew Survey Abst. No. 136, continue on North with WB line of said Dew Survey about 1650 vrs. to the NW corner of a 102 acre tract formerly owned by Geo. Lea Keith;
- THENCE East about 1375 vrs. a stake;
- THENCE North about 275 vrs. a stake in the NB line of Mrs. P. H. Hobbs tract in said J. J. Dew Survey;
- THENCE East 750 vrs. the SW corner of a 77.5 acre tract owned by C. F. Rogers;
- THENCE North with Rogers WB line 500 vrs. his NW corner;
- THENCE West 750 vrs. a stake the NW corner of the M. Biffle et al 81 acre tract;
- THENCE North 1500 vrs. a stake in EB Line of Hoffman Club Lake property;
- THENCE East 500 vrs., the SW corner of the A B & G Gilpin 80 acre tract;
- THENCE North with WB line of Gilpin tract 875 vrs. the NW corner of same;
- THENCE East 450 vrs. with WB line Gilpin tract, which is also NB line of said J. J. Dew Survey, to the NE corner of Gilpin tract;
- THENCE North 1000 vrs. the NE corner of the C. M. Gingles 200 acre tract in the Jas. W. Green Survey Abst. No. 229;
- THENCE in a NE direction 600 vrs. the SW corner of Steve Sanders 20.8 acre tract;
- THENCE North 500 vrs. with Sanders WB line to his NW corner;
- THENCE East 750 vrs. to the WB line of 116 acre tract of said Renford Justias;
- THENCE North 250 vrs. to the NE corner of a 13 acre tract owned by C. C. Hammond;
- THENCE West 85 vrs. to the SE corner of a 87 acre tract owned by M. E. Elliott;
- THENCE North 2375 vrs. along the West Bound Line of Renford Justias; C. B. Harrell and Son Williams to the South Bound line of W. D. Burnett Survey;
- THENCE West 1287 1/2 vrs. to the South East corner of a 25 acre tract owned by Horace Thompson;
- THENCE North 2250 vrs. to the South East corner of a 60 acre tract owned by J. M. Stephenson Estate;
- THENCE West 500 vrs. to the South West Corner of the J. M. Stephenson Estate;
- THENCE North 1750 vrs. along West B line of the J. M. Stephenson and C. S. Newman to the BBB & CRR Sur-A-80;
- THENCE East 1000 vrs. to the SW Corner of J. A. Brook Survey No. A-47 and SW Corner of Jim Stephenson;
- THENCE North 1225vrs. along WB of Jim Stephenson to White Oak Creek;
- THENCE East down White Oak Creek with the meandering there of to a point of East Bound of the P. H. Pewitt 640 acres and West Bound of the Wm. F. Savags Survey;
- THENCE South 500 vrs. to the SE corner of a 640 tract owned by P. H. Pewitt, W. C. Butte Survey;
- THENCE West 750 vrs. to the Northwest corner of the Elisha Bruton Sur-A-61 and the NE corner of 1068.3 acres owned by P. H. Pewitt;
- THENCE South 2250 vrs. to the NW corner of Benj. Clark Sur-A-104 and NE corner of a tract owned by O. H. Lilly;
- THENCE West 1845 vrs. to the NE corner of a 50 acre tract owned by Nannie Tigert;

THENCE South 1845 vrs. to the SE corner of 110 acre tract owned by G. V. Powell;  
 THENCE West 750 vrs. to the SW corner of a 110 acre tract owned by G. V. Powell;  
 THENCE North 125 vrs. to the SE corner of a 97 acre tract owned by Bertie Wilhite;  
 THENCE WEST 625 vrs. to the NW corner of a 93 acre tract owned by Joe Heath;  
 THENCE South 1000 vrs. along the West side of Joe Heath's 93 acre tract;  
 THENCE West 500 vrs. to the NE corner of a 100 acre tract owned by A. E. Crooka and along the South Bounds  
 of the G. W. Smith Survey;  
 THENCE South 1625 vrs. to a SE corner of the P. F. Newman 100 acre tract;  
 THENCE West 125 vrs. to a stake;  
 THENCE South 3250 vrs., the SB line of Hopkins Survey, same being the SW corner of the Mrs. J. L. Porter  
 117 acre tract;  
 THENCE East 200 vrs. with SB line of Hopkins Survey and NB line of R. E. Beatty Survey Abst. No 50 a  
 stake;  
 THENCE South about 475 vrs. the SB line of Beatty Survey;  
 THENCE East 875 vrs. with SB line of Beatty Survey a stake, the same being the NE corner of the John Douglas  
 Survey Abst. No 168;  
 THENCE South 430 vrs. the SE corner of the J. L. Porter 159.5 acre tract;  
 THENCE West 1000 vrs. with Porter's SB line a stake, same being Gus E. Talborn NW corner;  
 THENCE IN A SE direction 500 vrs. with Talborn WB line a stake in the NB line of Lewis H. Bradley Abst.  
 No. 21;  
 THENCE West 275 vrs. with NB line of Bradley Survey the NW corner of W. H. Harbour 50 acre tract;  
 THENCE with Harbour's WB line 1325 vrs. the SW corner of the Harbour tract;  
 THENCE west 250 vrs. the WB line of Bradley Survey;  
 THENCE South with WB line of Bradley Survey 1250 vrs., the SW of Bradley Survey, continue on South a total  
 of 2450 vrs. to the place of beginning.

(Xerox copy of the relevant portion of the above map is attached hereto as "EXHIBIT 1")  
 It is accordingly ORDERED that on the 1st day of April, 1978, such election shall be held throughout the  
 Harts Bluff Common School District to determine the above stated proposition and to select a board of trustees  
 consisting of seven members to serve as trustees for said independent school district, if same be incorporated.  
 IT IS FURTHER ORDERED that such election shall be held and conducted and returns thereof made in accordance  
 with Chapter 19, Subchapter C of the Texas Education Code with the election to be held between the hours  
 of 7 o'clock a.m. and 7 o'clock p.m. at the gymnasium of the Harts Bluff Common School District, and Rita  
 Justice is appointed as the presiding officer over said election proceedings.  
 IT IS FURTHER ORDERED that the Sheriff of Titus County, Texas, not less than 10 days prior to the date  
 set for this election, shall post a copy of the notice of election in 3 different public places within the  
 boundaries of Harts Bluff Common School District as same are described in this election order, and make due  
 return thereof.  
 IT IS ORDERED that this order shall be entered upon the minutes of the Commissioners Court of Titus  
 County, Texas.  
 SIGNED this 13th day of March, 1978.

/s/ William Wayne Landrum  
 County Judge of Titus County, Texas

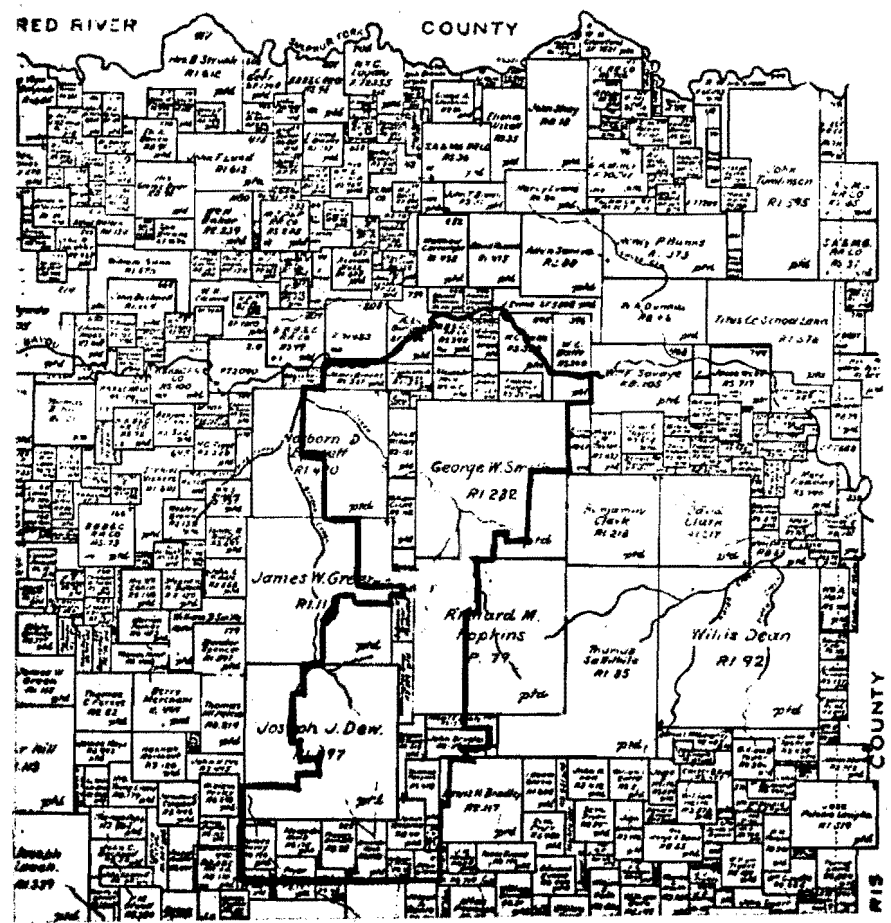

SPECIAL SESSION  
MARCH 24, 1978

BE IT REMEMBERED THAT THE TITUS COUNTY COMMISSIONERS COURT met in Special Session, Friday March 24, 1978, in the Titus County Courtroom with all members present.

William Wayne Landrum	County Judge
C.H. Reese	Commissioner Precinct 1
Bert Parr	Commissioner Precinct 2
Alvin Parish, Jr.	Commissioner Precinct 3
Bill Reynolds	Commissioner Precinct 4
Allen LaPrade	County Clerk

and the following proceedings were had to-wit:

IN THE MATTER OF  
PAYING ROAD HANDS

Motion by Commissioner Parr and seconded by Commissioner Reese to pay county road hands upon approval of County Auditor. Motion carried.

IN THE MATTER OF  
ACCEPTING PLAT

Motion by Judge Landrum and seconded by Commissioner Parish to accept from R.L. Thomas a plat of Pleasant Springs Subdivision for filing only. Dedication of streets not acceptable as no streets are build as of yet. Motion carried.

IN THE MATTER OF  
PAYMENT TO FOWLER FENCE

Motion by Commissioner Reynolds and seconded by Commissioner Parr to approve payment of \$10,600.00 as partial payment to Fowler & Sons, for building fence along highway 1735. Motion carried.

IN THE MATTER OF  
APPROVING BOND FOR JACKIE SHELLEY

Motion by Judge Landrum and seconded by Commissioner Parr to approve bond for Jackie Shelley as Interim Treasurer. Motion carried.

IN THE MATTER OF  
APPOINTING INTERIM TREASURER

Motion by Commissioner Parr and seconded by Commissioner Parish, due to the death of County Treasurer C.C. Clark, to appoint Jackie Shelley as Interim Treasurer, to serve in the capacity of Treasurer of Titus County until the general election in November 1978. The conditions of this appointment was that Jackie was not interested in running for office. She assured the court that she had no intention of running for the office. Motion carried.

The above and foregoing minutes of the month of March 1978, were read and approved on this the 12 th day of April 1978.

ATTEST: Allen LaPrade  
ALLEN LAPRADE, COUNTY CLERK

WILLIAM WAYNE LANDRUM, COUNTY JUDGE

REGULAR SESSION  
APRIL 10, 1978

BE IT REMEMBERED THAT THE TITUS COUNTY COMMISSIONERS COURT met in Regular Session, Monday April 10, 1978, in the Titus County Courtroom with all members present.

William Wayne Landrum	County Judge
C.H. Reese	Commissioner Precinct 1
Bert Parr	Commissioner Precinct 2
Alvin Parish, Jr.	Commissioner Precinct 3
Bill Reynolds	Commissioner Precinct 4
Allen LaPrade	County Clerk

and the following proceedings were had to-wit:

IN THE MATTER OF  
PAYING ROAD HANDS

Motion by Commissioner Reynolds and seconded by Commissioner Parr to pay road hands upon approval of County Auditor. Motion carried.

IN THE MATTER OF  
PAYING BILLS

Motion by Commissioner Reese and seconded by Commissioner Parrish to pay monthly bills upon approval of County Auditor. Motion carried.

IN THE MATTER OF APPROVING  
OFFICERS MONTHLY REPORTS

Motion by Commissioner Reynolds and seconded by Commissioner Parr to approve officers monthly reports upon approval of County Auditor. Motion carried.

IN THE MATTER OF APPROVING  
OFFICERS EXPENSE ACCOUNTS

Motion by Commissioner Parr and seconded by Commissioner Reynolds to approve officers monthly expense accounts. Upon approval of County Auditor. Motion carried.

IN THE MATTER OF CANVASSING COUNTY  
SCHOOL TRUSTEE ELECTION

Motion by Commissioner Parish and seconded by Commissioner Reese to approve the county school trustee election results as follows. Motion carried.

ELECTION RESULTS  
TRUSTEE ELECTION OF APRIL 1, 1978

STATE OF TEXAS  
COUNTY OF TITUS

The Commissioners Court of Titus County, Texas, meeting in Regular session on this the 10 day of April 1978, canvassed the elections for County Trustees of Titus County and declare the results as follows: